

**CITY OF RIVERSIDE COUNCIL MEETING AGENDA**  
**RIVERSIDE FIRE DEPARTMENT**  
**271 E 1<sup>ST</sup> ST**  
**REGULAR MEETING**

Monday, September 21, 2020 – 6:00 P.M.

The meeting will be recorded and can be viewed live by visiting the city web site at [www.riversideiowa.gov](http://www.riversideiowa.gov)

**NOTICE TO THE PUBLIC:** This is a meeting of the City Council to conduct the regular business of the City. Every item on the agenda is an item of discussion and action if needed.

1. Call meeting to order
2. Approval of agenda
3. Consent agenda
  - a. Minutes from 9-8-2020
  - b. Expenditures for 9-21-2020
  - c. RFD August monthly report
4. **Public forum:** 3 minutes per person. See guidelines for public comments at the Clerk's table.
5. Public hearings
  - a. Resolution #092120-01 Set public hearing for code changes – No parking **pg.6**
6. Kevin Meller-RACC update on future event
7. PeopleService Inc August monthly report
8. MMS Consultants report
  - a. Updates on 4<sup>th</sup> Street Project
    - i. Resolution #092120-02 Change Order #7 \$750.00 **pg. 19**
    - ii. Resolution #092120-03 Pay Request #5 J&L Construction \$282,804.31 **pg.22**
  - b. Updates on Safe Routes to School Project
    - i. Adding Crosswalk Markings at intersections
9. Resolution #092120-04 Donation of used Fire Department Ambulance to Washington County Ambulance **pg. 27**
10. Resolution #092120-05 Fire Department Request to Purchase New Vehicle **pg.28**
11. City Administrator's report
  - a. August financial report **pg. 56**
  - b. Trick or Treat night
  - c. Request to list rental property with real estate agent
  - d. FEMA/State grants
  - e. Community center design
  - f. Park comprehensive plan: Work session 9/28 6:00 PM
12. Motion to adjourn

Meeting attendees are asked to maintain 6 ft. distance from other attendees who don't live in their household. Masks are required when distancing cannot be maintained. Those wishing to provide comments for the public forum without attending the meeting can submit them by email to [admin@cityofriversideiowa.com](mailto:admin@cityofriversideiowa.com), by phone at 319-648-3501, or in the City Hall dropbox up to 30 minutes prior to the meeting.

## COUNCIL PACKET

RIVERSIDE CITY COUNCIL MEETING: Tuesday, September 8<sup>th</sup>, 2020

The Riverside City Council meeting opened at 6:00 pm at the Fire Station with Mayor Allen Schneider requesting roll call. Council members present were: Andy Rodgers, Edgar McGuire, Lois Schneider, Jeanine Redlinger and Tom Sexton.

Motion by Sexton to approve agenda. Second by Rodgers, passed 5-0.

Rodgers moved to approve the minutes of August 17<sup>th</sup>, 2020, expenditures, and liquor license for RACC demo derby. Second by Redlinger, passed 5-0.

Carol Riggan shared her views on holding a Demo Derby during a pandemic.

Ellis Helmuth returned to Council for permission to hold a fund raising slow pitch tournament at Hall Park. Mayor Schneider asked for a vote of council. Request passed 3-2, Schneider and Redlinger opposed.

Kevin Meller, RACC treasurer, reported on the August movie in the park. They are making plans for one more movie in September and a possible band in October.

Copper Creek owners, Matt and Kelly Wood reviewed the Economic Development Agreement with Council.

Council discussed donating Riverside Ambulance truck to Washington County. Chief Smothers will reach out to them.

Admin Yancey presented grant applications. Rodgers moved to fund three Residential, and two Commercial grants for a total of \$14,126.97. Second by Schneider, passed 5-0.

Council will consider Trick or Treat options at next meeting.

Redlinger moved to pass the 3<sup>rd</sup> and final reading of Ordinance #080320-06, Accepting the Code of Ordinance for the City of Riverside. Second by Rodgers, passed 5-0.

Schneider moved to allow Yancey to attend IMFOA conference in October. Second by Sexton, passed 5-0.

Rodgers moved to pass Resolution #090820-01, Approving Street Financial Report for FY20. Second by McGuire, passed 5-0.

Sexton moved to pass Resolution #090820-02, Approving Transfer of funds for FY21.

\$100,000 from Casino Funds to Capital Projects

\$75,000 from LOST to Capital Projects

\$50,000 from LOST to Capital Projects

Second by Rodgers, passed 5-0.

COUNCIL PACKET

McGuire moved to pass Resolution #090820-03, Forming a Citizen Advisory Committee Task Force. Second by Schneider, passed 5-0.

Rodgers moved to pass Resolution #090820-04, Approving Annual Urban Renewal report for FY20. Second by McGuire, passed 5-0.

Scott Pottorff, MMS Consultants gave updates on the 4<sup>th</sup> Street Project.

Jay Peiffer, J&L Construction, asked for additional working days due to delays from Mid American Gas Company to relocate gas line.

Schneider moved to extend contract by adding 15 working days. Second by McGuire, passed 5-0.

Redlinger moved to pass Resolution #090820-05, Approving Change Order #6 to remove and replace additional driveway at 320 E 4<sup>th</sup> Street. Second by Rodgers, passed 5-0.

Sodding is completed on the Safe Route to School Project. Mayor asked for consideration of painting cross walks to be on next meeting agenda.

Mayor gave update on park improvements Committee meeting. Next public meeting for park improvements will be September 22 at 6:30 pm in Fire Station meeting room.

Yancey is working with FEMA and State applications for COVID-19 funds. Funds for a City Hall generator may take two years.

Redlinger moved to adjourn at 8:14 pm. Second by Rodgers, passed 5-0

Full content of Council Meetings can be viewed on the City web site; [riversideiowa.gov](http://riversideiowa.gov)

Council Meeting – Monday, September 21<sup>st</sup>, 2020 at 6:00 p.m. at Fire Station.

PARKS Open Meeting - Tuesday, September 22<sup>nd</sup>, 2020 at 6:30 p.m. at Fire Station.

ATTEST:

  
\_\_\_\_\_  
Becky LaRoche; City Clerk

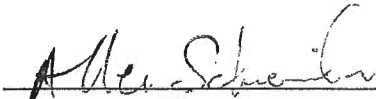
  
\_\_\_\_\_  
Allen Schneider; Mayor

# COUNCIL PACKET

EXPENDITURES 09-21-20					
COUNCIL MEETING		UNPAID BILLS:			
1	BECKY LAROCHE	SEICCA MILEAGE	001-5-650-6240	\$	41.40
2	COLBERT CARPET CARE	RFVD	002-5-150-6310	\$	426.70
3	DOORS INC	CLOSER	001-5-650-6509	\$	370.00
4	GAMBLES	RVFD	002-5-150-6310	\$	12.57
5	ICC	CODE BOOKS	001-5-650-6506	\$	712.92
6	IOWA RIVER TREE SERVICE	STORM CLEAN UP	001-5-510-6495	\$	6,350.00
7	IOWA SOLUTIONS	SERVICE	001-5-650-6497	\$	202.50
8	J&L CONSTRUCTION	CONCRETE RR PARK	001-5-430-6325	\$	172.50
9	J&L CONSTRUCTION	LS FUEL	610-5-815-6331	\$	274.00
				\$	446.50
10	JETCO	WTP -VFD	600-5-810-6507	\$	9,175.00
11	JOHNSON COUNTY REFUSE	SEPT SERVICE	670-5-840-6499	\$	7,297.50
12	KALONA AUTO	PARKS	145-5-650-6422	\$	34.10
13	KALONA GRAPHICS	ENVELOPES	600-5-810-6506	\$	208.91
14	KUENSTER	WW PLANT	610-5-815-6332	\$	918.91
15	LEAF	COPIER LEASE	001-5-650-6496	\$	156.50
16	MMS	ENGINEERING	001-5-650-6407	\$	477.50
17	MMS	ASH/TUPELO	301-5-750-6789	\$	1,799.75
18	MMS	4TH STREET	301-5-750-6777	\$	9,844.44
19	MMS	PARKS PLAN	301-5-750-6779	\$	1,250.00
				\$	13,371.69
20	OFFICE EXPRESS	C HALL	001-5-650-6506	\$	459.21
21	OFFICE EXPRESS	SHOP	001-5-210-6506	\$	36.71
				\$	495.92
22	RACC	PARK MOVIE	145-5-650-6415	\$	435.00
23	REC	SIGN	001-5-520-6510	\$	73.14
24	REC	LIFT STATION	610-5-815-6371	\$	51.10
25	REC	WW PLANT	610-5-815-6371	\$	3,402.30
26	REC	SHOP	001-5-210-6371	\$	48.34
27	REC	WATER PLANT	600-5-810-6371	\$	2,197.00
28	REC	TRAFIC LIGHT	001-5-230-6371	\$	156.42
29	REC	CASINO L/S	610-5-815-6371	\$	214.90
				\$	6,143.20
30	STANDARD PEST CONTROL	SEPT SERVICE	001-5-650-6310	\$	60.00
31	US CELLULAR	C HALL	001-5-650-6373	\$	48.73
32	US CELLULAR	RVFD	002-5-150-6332	\$	95.31
				\$	144.04
33	VISA	PARKS	001-5-430-6323	\$	65.79
34	VISA	OFFICE	001-5-650-6506	\$	5.48
35	VISA	USTREAM	001-5-650-6494	\$	99.00
36	VISA	DOOR BELL	001-5-650-6310	\$	35.30
37	VISA	GoToMeeting BUSINESS	001-5-650-6497	\$	5.30
38	VISA	LEAGUE CONFERENCE	001-5-650-6240	\$	50.00
				\$	260.87
39	WA. CO. RECORDER	CHERRY LN	001-5-650-6401	\$	313.00
40	WA. CO. TRESURER	CHERRY LN TAX	301-5-7550-6772	\$	78.00
41	WA. CO. TRESURER	40 E 2ND ST	001-5-470-6310	\$	1,184.00
42	*****	<b>TOTAL BILLS</b>		<b>\$</b>	<b>48,839.23</b>
43					
44		PAID BILLS:			
45	IOWA DEPT OF REVENUE	IOWA WITHHOLDINGS - 2020 AUG	\$	1,012.00	
46	IOWA DEPT OF REVENUE	IOWA SALES TAX - 2020 AUG	\$	1,287.00	
47	IOWA DEPT OF REVENUE	IOWA WET TAX - 2020 AUG	\$	2,002.00	
48	IPERS	CONTRIBUTIONS - 2020 AUG	\$	4,114.00	
49	IRS	941 TAX DEPOSIT - 2020 AUG	\$	5,578.36	
50	PAYROLL	PAYROLL - 2020 AUG	\$	20,622.59	
51	1ST NAT'L BANK	HEALTH SAVINGS ACCOUNT	\$	1,500.00	
52		TOTAL PAID BILLS		\$	36,115.95
53	*****	<b>TOTAL EXPENDITURES</b>		<b>\$</b>	<b>84,955.18</b>
54					
55	<b>GENERAL FUND</b>		<b>\$</b>	<b>11,123.74</b>	
56	<b>FIRE DEPARTMENT</b>		<b>\$</b>	<b>534.58</b>	
57	<b>ROAD USE FUND</b>		<b>\$</b>	<b>-</b>	
58	<b>CASINO FUNDS</b>		<b>\$</b>	<b>469.10</b>	
59	<b>DEBT SERVICE</b>		<b>\$</b>	<b>-</b>	
60	<b>CAPITAL PROJECTS</b>		<b>\$</b>	<b>12,972.19</b>	
61	<b>WATER FUND</b>		<b>\$</b>	<b>11,580.91</b>	
62	<b>SEWER FUND</b>		<b>\$</b>	<b>4,861.21</b>	
63	<b>GARBAGE</b>		<b>\$</b>	<b>7,297.50</b>	
64	<b>TOTAL EXPENDITURES</b>		<b>\$</b>	<b>48,839.23</b>	
65					
66					
67					

## COUNCIL PACKET

68	MTD TREASURERS REPORT	8/31/2020	REVENUES	EXPENSES	BALANCE
69	GENERAL FUND		\$ 6,421.94	\$ 53,548.64	\$ 256,803.74
70	FIRE DEPT FUND		\$ -	\$ 3,930.22	\$ 85,315.46
71	ROAD USE TAX FUND		\$ 10,507.53	\$ 1,845.50	\$ 181,119.14
72	LOCAL OPTION SALES TAX		\$ 10,219.44	\$ -	\$ 271,602.12
73	CASINO REVENUE RUND		\$ 109,421.12	\$ 667.07	\$ 270,571.92
74	DEBT SERVICE		\$ -	\$ -	\$ -
75	CAPITAL PROJECTS FUND		\$ 8,381.93	\$ 232,235.87	\$ 167,688.26
76	COMMUNITY CENTER FUNDS		\$ 3,502.08	\$ -	\$ 914,205.38
77	WATER FUND		\$ 37,628.54	\$ 24,991.67	\$ 530,300.96
78	SEWER FUND		\$ 69,662.19	\$ 35,642.29	\$ 260,323.97
79	GARBAGE/LANDFILL FUND		\$ 7,410.39	\$ 7,143.50	\$ 10,101.28
80	STORM WATER FUND		\$ 1,603.39	\$ -	\$ 7,752.74
81	<b>TOTAL</b>		<b>\$ 264,758.55</b>	<b>\$ 360,004.76</b>	<b>\$ 2,955,784.97</b>

**RIVERSIDE FIRE  
DEPARTMENT**

**FIRE / RESCUE / EMS / HAZMAT**



**August 2020 Update**

**Calls for Service:**

- Medicals - 16
- Structure Fires – 1
- Motor Vehicle Accidents – 2
- Gas Line Hit – 1

**Total calls – 20 calls for service in August**

RFD responded to a mix of calls for the month of July, the call volume has picked back up since the start of COVID.

**Training:**

The members trained water supply, search and rescue, fire attack and hose management. All of this was done out at our training facility and under live fire conditions. The members performed all skills at a high level and continue to always look for improvement and chase perfection.

**RESA:**

The annual raffle dinner that we held at the VFW has been canceled due to COVID. The members have been discussing other options for a fundraiser, maybe some type of silent auction.

**Other News**

The department is working through changes with the new county ambulance service and response times will be coming from Deputy Chief Hancock. The department is still working on some new members to fill openings. The department is looking at replacing the old ambulance vehicle with a pickup type truck with a topper and slideout that holds our medical, grain bin and water rescue equipment. This vehicle will cost roughly \$50,000 from our equipment replacement account. The RESA members will fund \$15,000 that includes the topper, slideout and other accessories and graphics. There will be more on this project in an email and request at a council meeting from Chief Smothers.

**“WE”RE STILL HERE AND READY TO RESPOND”**

Thanks  
Chief Smothers

**RESOLUTION #092120-01**

**RESOLUTION TO SET THE DATE FOR PUBLIC HEARING TO  
UPDATE PARKING ORDINANCE**

**WHEREAS**, the City of Riverside, Iowa, will set the date to hold a public hearing to update Parking Ordinance of the City Code of Ordinance Chapter 69. Hearing will be at the Riverside Fire Station on October 5<sup>th</sup>, 2020, which begins at 6:00 p.m., in the Meeting room, located at 271 E 1<sup>st</sup> Street, Riverside, Iowa.

**THEREFORE, BE IT RESOLVED**, The City of Riverside City Council, hereby approves the date for the Public Hearing.

**IT WAS MOVED BY** Councilperson \_\_\_\_\_, seconded by Councilperson \_\_\_\_\_, to approve the foregoing resolution.

Roll Call: Schneider, Sexton, Rodgers, Redlinger, McGuire

Ayes:

Nays:

Abstain:

**PASSED AND APPROVED** by the City Council of Riverside, Iowa and approved this 5th day of October, 2020.

Signed: \_\_\_\_\_ Date: \_\_\_\_\_  
Allen Schneider, Mayor

Attest : \_\_\_\_\_ Date: \_\_\_\_\_  
Becky LaRoche, City Clerk

COUNCIL PACKET



Job No. \_\_\_\_\_  
 Sheet No. \_\_\_\_\_ Date \_\_\_\_\_  
 Calculated By \_\_\_\_\_ Date \_\_\_\_\_  
 Approved By \_\_\_\_\_ Date \_\_\_\_\_

**AWWA D.I. Cast Iron Pipe**

Nom. Size In.	Pressure Class D.I. Pipe	Pit Cast Gray Iron			
		A	B	C	D
3	3.86	3.80		3.96	
4	4.80	4.80		5.00	
6	6.90	6.90		7.10	
8	9.05	9.05		9.30	
10	11.10	11.10		11.40	
12	13.20	13.20		13.00	
14	15.30	15.30		15.65	
16	17.40	17.40		17.80	
18	19.50	19.50		19.92	
20	21.60	21.60		22.06	
24	25.80	25.80		26.32	
30	32.00	31.75	32.00	32.40	32.74
36	38.30	37.96	38.30	38.70	39.16
42	44.50	44.20	44.50	45.10	45.58
48	50.80	50.50	50.80	51.40	51.98
54	57.56	56.68	57.10	57.80	58.4
60	61.61	62.80	63.40	64.20	64.82
72		75.34	76.00	76.88	77.74

**Asbestos Cement Pipe**

Nom. Size In.	Mach End Class		** Rough Barrel Class		
	100	150/200	100	150	200
3	3.74	3.84	3.95	4.13	4.17
4	4.64	4.81	4.95	5.10	5.35
6		6.91		7.20	7.35
8		9.11		9.40	9.50
10	11.2	11.66	11.50		11.95
12	13.4	13.92	13.75		14.20
14	15.1	16.22	15.55	16.50	16.60
16	17.2	18.46	17.65	18.75	18.90

**Steel Pipe &**

**Steel Sized PVC Pipe**

Nom. Size In.	Standard (Schedule 40)	Nom. Size In.	Standard (Schedule 40)
1/2	0.840	4	4.50
3/4	1.05	4 1/2	5.00
1	1.315	5	5.563
1 1/4	1.66	6	6.625
1 1/2	1.90	8	8.625
2	2.375	9	9.625
2 1/2	2.875	10	10.75
3	3.50	12	12.75
3 1/2	4.00	14	14.00

Standard (Schedule 40) steel pipe 14" and above—the nominal size is the O.D. 16" = 16.00" O.D. etc.

**PVC Plastic Pipe**

Nom. Size In.	PIP Irrigation	Nom. Size In.	C-900 Cast Iron
4	4.130	4	4.80
6	6.140	6	6.90
8	8.160	8	9.05
10	10.200	10	11.10
12	12.240	12	13.20
15	15.300	15	15.30

**Copper Tubing**

Non. Size In.	Pipe OD	Nom. Pipe Size In.	Pipe OD In.
3/8	.500	1	1.125
1/2	.625	1 1/4	1.375
5/8	.750	1 1/2	1.625
3/4	.875	2	2.125

NO PARKING SOUTH SIDE OF STREET  
 Between WASH BURN and GLASGOW

NO PARKING HERE TO CORNER

3rd + ELLA ALL CORNERS

Keeper + SYCAMORE SE CORNER

3rd + GLASGOW NE CORNER

2nd + GLASGOW ALL 4 CORNERS



COUNCIL PACKET

CITY OF RIVERSIDE IOWA

SUBDIVISION OF THE S.W. 1/4  
OF THE S.E. 1/4 SEC. 7-77-8

52327

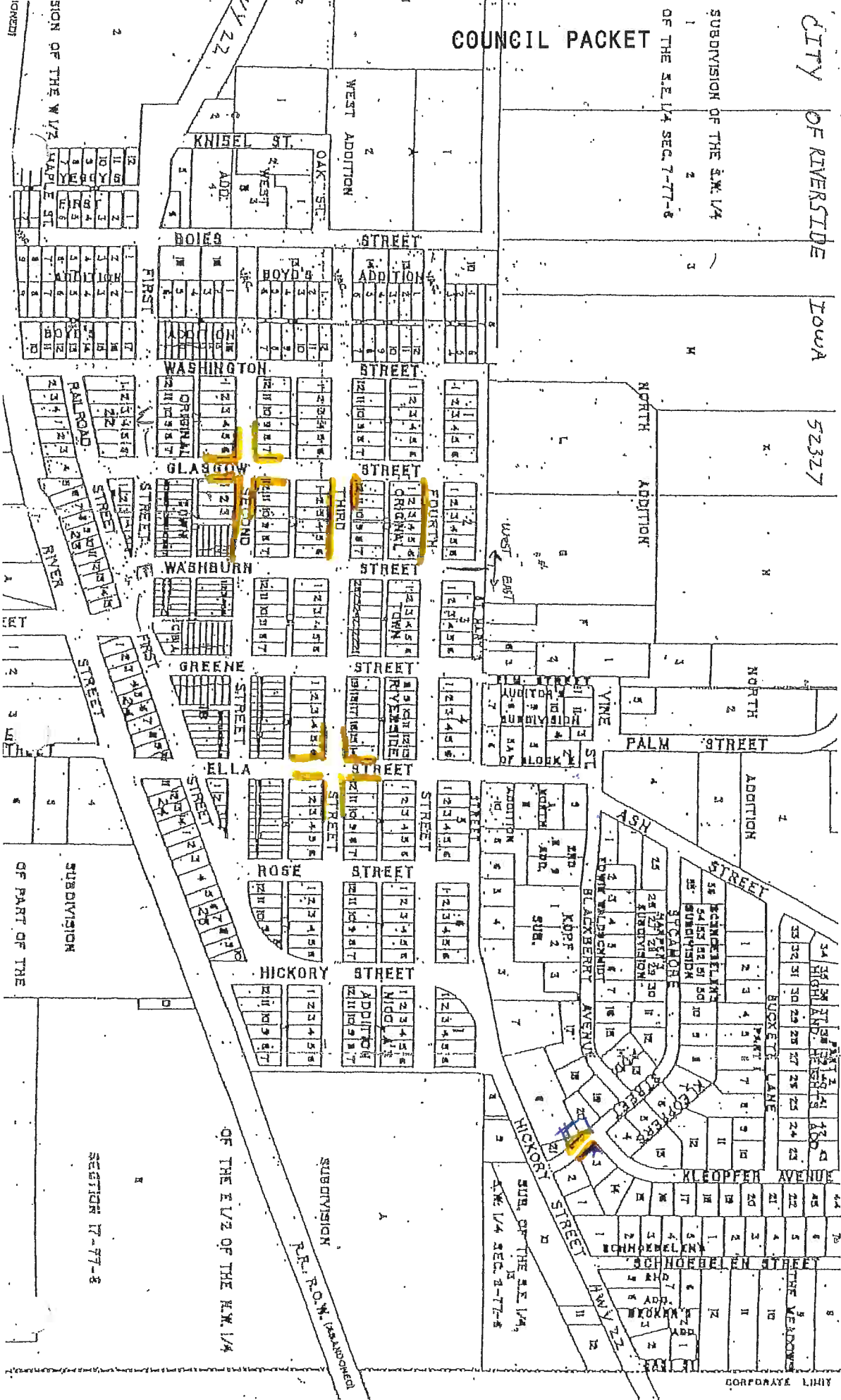

# No parking between signs

\* No parking here to come

## COUNCIL PACKET

### RIVERSIDE CITY COUNCIL MEETING: January 20, 2020

The Riverside City Council meeting opened at 6:30 pm in City Hall with Mayor Schneider requesting roll call. Council members present were: Tom Sexton, Andy Rodgers, Edgar McGuire, Jeanine Redlinger, and Lois Schneider.

Motion by Sexton to approve agenda. Second by Rodgers, passed 5-0.

McGuire moved to approve the minutes of January 6, 2020 and expenditures. Second by Schneider, passed 5-0.

Council received the December 2019 Fire Department report.

Chris Kirkwood asked Council about selling City equipment, wood give-a-way, and City Council meetings on website.

Bill Stukey, PeopleService, Inc. presented December 2019 water and waste water report.

Yancey presented Administrators Report.

Council received input from citizen's on updating Code of Ordinances with additional "no parking" on City Streets.

McGuire moved to approve no parking on south side of street on 2<sup>nd</sup>, 3<sup>rd</sup>, and 4<sup>th</sup> Streets from Washburn to Glasgow. No parking on all intersection corners on 3<sup>rd</sup> & Ella, SE corner of Kleopfer & Sycamore, NE corner of 3<sup>rd</sup> & Glasgow, and all corners of 2<sup>nd</sup> & Glasgow. Second by Schneider, passed 5-0.

Redlinger moved to advertise for sealed bids for the City owned Street packer that is in the south end of Hall Park. Bids will be opened at the February 18<sup>th</sup> City Council meeting. Second by Sexton, passed 5-0.

Redlinger moved to pass Resolution #012020-01, approving Real Estate listing agreement with Lepic-Kroeger Realty for selling City owned commercial lot. Second by McGuire, passed 5-0.

Sexton moved to pass 2<sup>nd</sup> reading of Ordinance #010620-03, approving rezoning parcel #04-083-550-15 on Blackberry Ave from P-1 Public to R-1 Residential. Second by McGuire, passed 5-0.

Redlinger moved to pass Resolution #012020-02, setting the date for Public Hearing on maximum tax dollars levied for proposed fiscal year 2020-2021 City Budget. Second by McGuire, passed 5-0.

Rodgers moved to pass resolution #012020-03, approving 2020 contract with Michael Hart, of Northland Securities, for financial planning at \$1500 per quarter. Second by McGuire, passed 5-0.

McGuire moved to pass Resolution #012020-04, approving Iowa Solutions for computer support at a setup fee of \$1525, and monthly service not to exceed \$290. Second by Schneider, passed 5-0.

Council reviewed stick pick-up program provided by Johnson County Refuse.

Rodgers moved to pass Resolution #012020-05, approving transfer of funds for budget year 2019-20. Second by Redlinger, passed 5-0.

## COUNCIL PACKET

### City Admin

---

**From:** Kevin Meller <kevinmeller26@gmail.com>  
**Sent:** Thursday, September 17, 2020 7:22 AM  
**To:** City Admin; Mayor  
**Subject:** Events in City Park

Good morning. Sorry for not getting this to you last night. I spaced it out getting the kids to bed and fell asleep myself.

I'd like to put together another movie night and a concert between now and the end of October. The dates would be on Saturdays. I would try to bring in two food trucks. I would also try to do them as two separate events if possible. The dates are TBD.

Total cost with movie/band and sound guy is approx \$1100.

- MovieNight
  - license approx \$300
  - sound \$100
- Concert
  - Band \$500
  - Sound \$100
- Misc
  - \$100

We will tackle social distancing by:

- not having seating set up near the stage. - have families bring blankets or chairs
- having a professional sound guy so we are not having inexperienced people having to troubleshoot to remember how to run the sound board.
- If it is deemed necessary we could spray paint markers of where to sit on the ground
- announce and remind people throughout the evening to social distance and wear masks when not possible
- scatter picnic tables throughout the park to keep large groups gathering to eat
- strongly encourage volunteers that are within six feet of each other to have on face masks

Other events:

- Many private businesses are hosting food trucks with bands - have done successfully without any reported outbreaks
- the last movie night in the Park in Riverside

We have found at the last movie night that Hall Park has the space to do social distancing.

Thanks,

Kevin

## COUNCIL PACKET



Date: September 9, 2020

To: Riverside Council

From: Bill Stukey, Operator

O & M Report: August 2020

### **Water Operation & Maintenance**

---

- Storm on 8-10-2020 did not affect power for most of town, but a large tree fell on the bike trail, causing a limb to twist some power wires together and drop one phase of power to lift stations 1 and 2. The generators for those stations ran continuously until 8-12-2020 when Alliant was able to remove the branch and restore full power.
- Consumer Co-op filled all the generators after power was restored. All generators are now full of fuel.
- I flushed hydrant no. 28 on Schnoebelen St. I had received a call about lightly rusty water.
- Well 8 VFD is installed and now fully operational again. I flushed the well thoroughly and have placed it back in service.
- I have sent out bid requirements to several well companies to put together a maintenance contract to inspect well 7. We should be inspecting each well every 3-5 years.
- 17 Door postings, 3 shutoffs. All shutoffs have been paid and turned back on.
- 24 locates, 1 emergency locate, 1 joint meet locate.

### **Wastewater Operation & Maintenance**

---

- I conducted a dye test on Edgar's floor drains and sump pumps to verify connection to storm drain. The floor drains are connected into the home's sanitary sewer and sump pumps have been connected into the new storm sewer.

COUNCIL PACKET



- I have been working with Engie to set up an RFP to dredge lagoon cell #1. They plan to have all bids in by 9-7-2020 and will be dredging the existing biosolids and lime sludge from cell one sometime this fall.

**Iowa Department of Natural Resources**

---

-

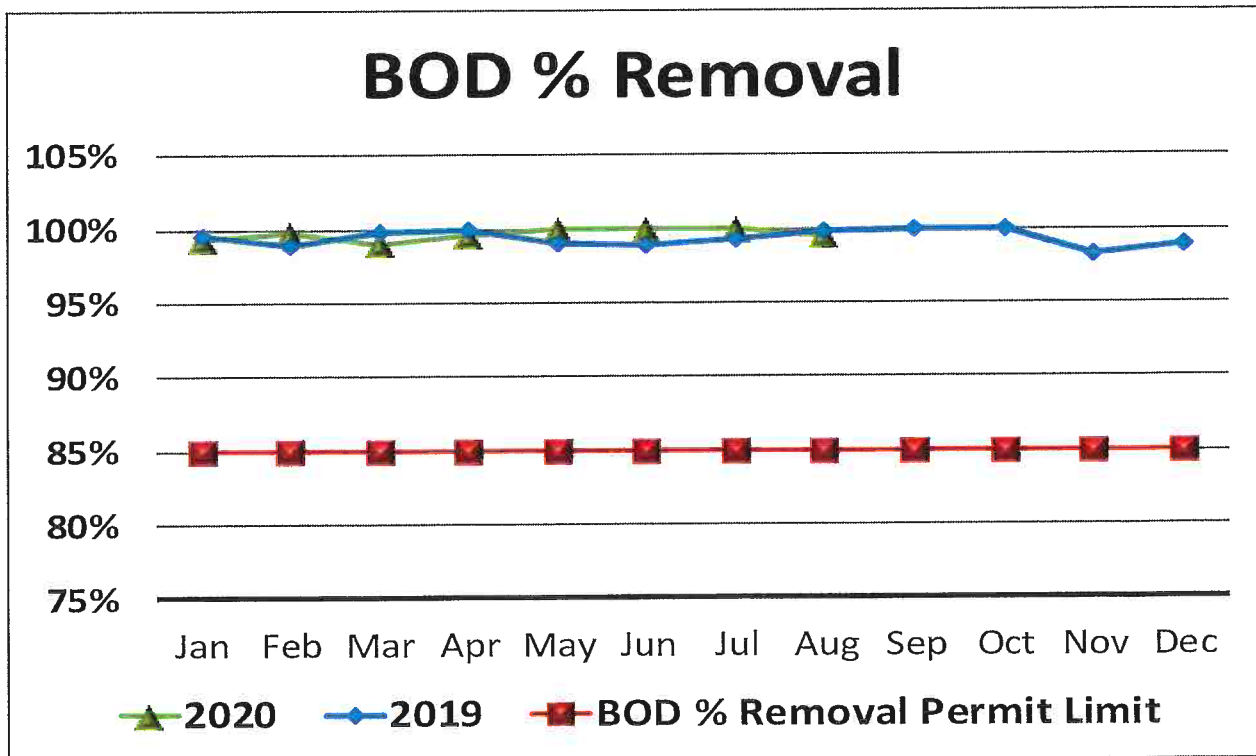
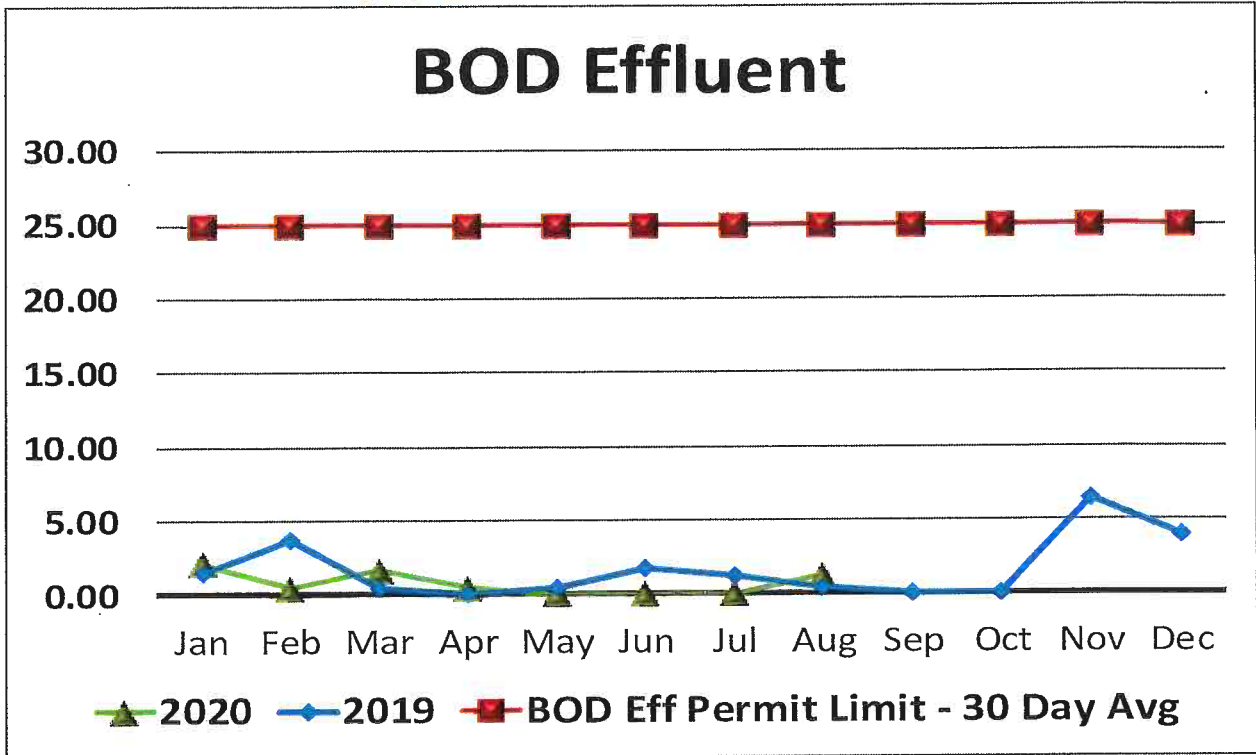

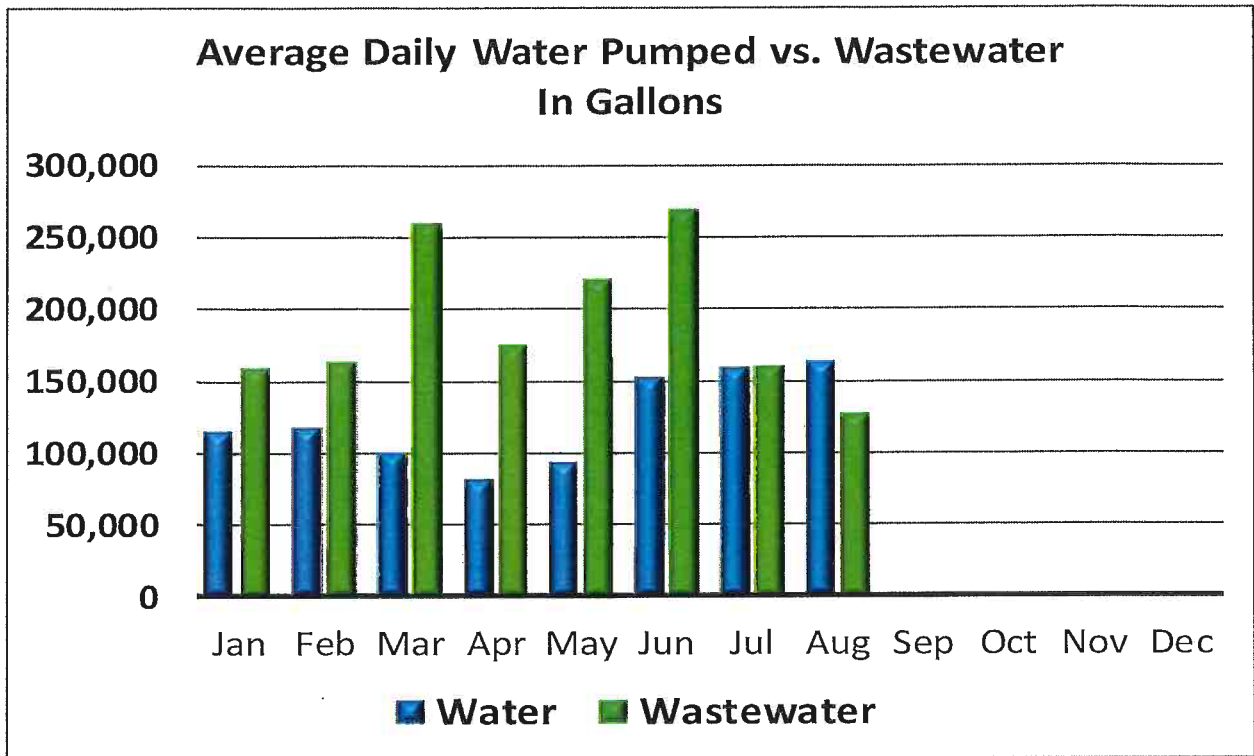

Contract True-Ups - Current Contract Year				
Item	Budgeted Amount	Amount Spent	% of Budget	% of Time
Chemical Budget	\$26,209.00	\$1,763.13	7%	17%
Maintenance Budget	\$21,840.00	\$1,212.59	6%	17%
<b>Total</b>	<b>\$48,049.00</b>	<b>\$2,975.72</b>	<b>6%</b>	<b>17%</b>

COUNCIL PACKET



		August-20	July-20	August-19
<b>Water</b>				
Total Monthly Pumped	gallons	5,071,000	4,929,000	4,763,000
Average Daily Pumped	gallons	163,580	159,000	153,650
Maximum Daily Pumped	gallons	367,000	330,000	224,000
Minimum Daily Pumped	gallons	10,000	0	108,000
<b>Chlorine</b>				
Chlorine - Total Avg Residual Plant	mg/L	1.41	1.59	0.82
Chlorine - Total Avg Residual System	mg/L	0.89	0.98	0.89
Chlorine - Recommended Residual System	mg/L	0.30	0.30	0.30
Chlorine used	lbs	183.00	178.00	172.00
<b>Iron</b>				
Iron - Avg Raw	mg/L	1.59	1.66	1.86
<b>Polyphosphate</b>				
Polyphosphate - Avg Residual	mg/L	0.99	1.71	1.32
Polyphosphate - Recommended Residual	mg/L	0.5 - 2.0	0.5 - 2.0	0.5 - 2.0
Polyphosphate used	lbs	28.50	14.00	30.50
<b>Water Loss</b>				
Water Billed	gallons	4,072,486	3,858,928	4,461,479
Water used in main breaks/hydrant flushing	gallons	50,000	25,000	15,000
Water used at city buildings	gallons	150	228,697	145,011
Loss	gallons	5%	14%	7%
<b>Wastewater</b>				
<b>BOD</b>				
BOD Influent Avg	mg/L	273	225	293
BOD Effluent Avg	mg/L	1	0.0	1
BOD Eff Permit Limit - 30 Day Avg	mg/L	25	25	25
BOD % Removal	%	99.54%	99.99%	99.82%
BOD % Removal Permit Limit	%	85%	85%	85%
<b>TSS</b>				
TSS Influent Avg	mg/L	163	170	222
TSS Effluent Avg	mg/L	2	0	5
TSS Effluent Permit Limit - 30 Day Avg	mg/L	30	30	30
TSS % Removal	%	98.61%	99.99%	97.83%
TSS % Removal Permit Limit	%	85%	85%	85%
<b>Nitrogen Ammonia</b>				
NA Effluent Avg	mg/L	<0.1	0	0
NA Effluent Permit Limit - 30 Day Avg	mg/L	5	5	5
<b>Influent Flow</b>				
Total Monthly	gallons	3,946,800	4,979,100	5,846,300
Average Daily	gallons	127,316	160,616	188,590
Maximum Daily	gallons	179,500	237,100	462,200
Minimum Daily	gallons	77,300	121,300	119,100
Permit Limit - 30 Day Avg	gallons	444,000	444,000	444,000
Permit Limit - Daily Maximum	gallons	1,425,000	1,425,000	1,425,000



COUNCIL PACKET



RIVERSIDE--AUGUST '20

Water Plant Maintenance

<u>Date</u>	<u>Vendor List</u>	<u>Description</u>	<u>Total</u>
8/18/20	Rhino Industries	Spare Prominent Part Set	\$385.16
8/22/20	First National Bank, VISA	Supplies	\$53.86
		<b>Total</b>	<b>\$439.02</b>

Water System Maintenance

<u>Date</u>	<u>Vendor List</u>	<u>Description</u>	<u>Total</u>
		<b>Total</b>	<b>\$0.00</b>

Wastewater Plant Maintenance

<u>Date</u>	<u>Vendor List</u>	<u>Description</u>	<u>Total</u>
		<b>Total</b>	<b>\$0.00</b>

Wastewater System Maintenance

<u>Date</u>	<u>Vendor List</u>	<u>Description</u>	<u>Total</u>
		<b>Total</b>	<b>\$0.00</b>

Water Plant Maintenance	\$439.02
Water System Maintenance	\$0.00
WW Plant Maintenance	\$0.00
WW System Maintenance	\$0.00
Month Total	<hr/> \$439.02

Annual Maintenance Budget \$21,840.00

Total Maintenance Dollars Spent Year to Date \$1,212.59

Percent Maintenance Budget Spent Year to Date 6%



COUNCIL PACKET



RIVERSIDE - AUGUST '20

Water System Chemicals

<u>Date</u>	<u>Vendor List</u>	<u>Description</u>	<u>Total</u>
8/24/20	Hawkins	Sodium Hypochlorite	\$380.25
8/24/20	Hawkins	Caustic	\$414.75
		<b>Total</b>	<b>\$795.00</b>

Wastewater System Chemicals

<u>Date</u>	<u>Vendor List</u>	<u>Description</u>	<u>Total</u>
		<b>Total</b>	<b>\$0.00</b>

Water System Chemicals	\$795.00
W/W System Chemicals	\$0.00
<b>Month Total</b>	<b>\$795.00</b>

Annual Chemical Budget \$26,209.00

Total Chemical Dollars Spent Year to Date \$1,763.13

Percent Chemical Budget Spent Year to Date 7%

Maintenance Month Total	\$439.02
Chemical Month Total	\$795.00
<b>Month Total</b>	<b>\$1,234.02</b>

Annual Budget \$48,049.00

Total Spent Year to Date \$2,975.72

Percent Budget Spent Year to Date 6%

# COUNCIL PACKET



## Work Orders Completed

Date completed	Equipment	Task
8/18/2020	BLOWERS	Monthly PM
8/3/2020	WWTP GENERATOR	Monthly PM
8/3/2020	LIFT STATION #1	LS Monthly PM
8/3/2020	LIFT STATION #2	LS Monthly PM
8/3/2020	LIFT STATION #3	LS Monthly PM
8/3/2020	LIFT STATION #4	LS Monthly PM
8/3/2020	LIFT STATION #5	LS Monthly PM
8/3/2020	MAIN LIFT STATION	LS Monthly PM
8/3/2020	EFFLUENT SAMPLER	Monthly PM
8/3/2020	INFLUENT SAMPLER	Monthly PM
8/3/2020	SCREEN UNIT	Monthly PM
8/18/2020	UV SYSTEM	Monthly PM
8/3/2020	FIRE EXTINGUISHERS	Inspection
8/3/2020	FILTER	Monthly PM
8/3/2020	CARTRIDGE FILTERS	Monthly PM
8/3/2020	DEHUMIDIFIERS	Monthly PM
8/3/2020	WATER PLANT GENERATOR	Monthly PM
8/3/2020	HIGH SERVICE PUMPS	Monthly PM
8/3/2020	WATER PLANT HEATER	Inspection
8/3/2020	FIRE EXTINGUISHERS	Inspection

COUNCIL PACKET

RESOLUTION #092120-02

RESOLUTION APPROVING CHANGE ORDER #7 TO  
J&L CONSTRUCTION FOR THE 4<sup>TH</sup> STREET PROJECT

**Whereas**, the City of Riverside City at the recommendation of the City Engineering Firm, MMS Consultants, Scott Pottorff and it is the opinion of the City Engineering Firm that the City Council accept this change order in the amount of \$750.00.

**Therefore**, be it resolved the City of Riverside City Council does hereby accept the Change Order #7 to lower the water service at 310 N rose Street.

It was moved by Councilperson \_\_\_\_\_ seconded by Councilperson \_\_\_\_\_, to approve the foregoing resolution.

**Roll Call:** Schneider, Sexton, Rogers, Redlinger, McGuire

Ayes:

Nays:

Absents:

**PASSED AND APPROVED** by City Council of Riverside, Iowa, on this 21st day of September, 2020.

Signed: \_\_\_\_\_ Date \_\_\_\_\_

Allen Schneider, Mayor

Attest: \_\_\_\_\_ Date \_\_\_\_\_

Becky LaRoche, City Clerk



**MMS Consultants, Inc.**  
*Experts in Planning and Development Since 1975*

1917 S. Gilbert Street  
 Iowa City, Iowa 52240  
 319.351.8282  
 mmsconsultants.net  
 mms@mmsconsultants.net

September 16, 2020

2245-045

**4th Street Improvements Project  
 Change Order #7**

The following changes to the contract are requested to lower the water service at 310 N. Rose Street.

There are existing bid items which cover some of the work in this change. Other parts were done on a time and materials basis as shown on the attached sheet. The changes required are as follows:

**EXISTING ITEMS**

<u>Item</u>	<u>Est Quantity</u>	<u>Unit Price</u>	<u>Total Estimated Cost</u>
Granular Driveway Surfacing, Class A Crushed Stone	3 TONS	\$30.00	\$90.00

**NEW ITEMS**

<u>Item</u>	<u>Est Quantity</u>	<u>Unit Price</u>	<u>Total Estimated Cost</u>
Lower Water Service at 310 N. Rose Street	1 LS	\$660.00	\$660.00
<b>TOTAL CHANGE</b>			<b>\$750.00</b>

**Change to the Contract**

This change order would add the above quantity to the the above item in the contract and add the above item to the contract and increase the amount of the contract by \$750.00.

**Reason for changes**

When the grade was cut down for the sidewalk at the NW corner of the intersection of 4th Street and Rose Street, the contractor checked the depth of the existing water service and found it to be too shallow. They lowered the service line from the curb stop to behind the proposed retaining wall to ensure enough cover to protect from freezing. The granular material was used to help backfill the trench to prevent settling.

Approved by:

\_\_\_\_\_  
 J&L Construction

\_\_\_\_\_  
 City of Riverside

2245045changeorder7.docx

Environmental Specialists  
 Landscape Architects  
 Land Planners  
 Land Surveyors  
 Civil Engineers

COUNCIL PACKET

**J & L CONSTRUCTION, LLC**

1971 Lexington Blvd.  
Washington, IA 52353  
Ph: (319) 653-3597  
Fax: (319) 653-2410  
Email: [jlconstr@cloudburst9.net](mailto:jlconstr@cloudburst9.net)



**PROPOSED CHANGE ORDER # 1**

To: City of Riverside  
60 N. Greene Street  
Riverside, IA 52327

Project: 4<sup>th</sup> St. Improvements  
City of Riverside, Iowa

Re: Time/Material Costs to lower  
water service at 310 N. Rose St.

This change order is to cover time & material costs involved to lower the water service at 310 N. Rose St.:

Qty.	Description		Unit Price	Ext. Price
4 Hrs.	Mini excavator with operator	@	\$165.00/Hr	\$ 660.00
3 TN	Granular driveway surfacing, Class A crushed stone (line item # 56)	@	\$ 30.00/Tn	\$ 90.00
	TOTAL			\$ 750.00

Dated: September 14, 2020

Date: \_\_\_\_\_

Submitted by:  
*Jay Peiffer*, Vice President  
J & L Construction, LLC  
Cell: (319) 530-0168

Approved by:  
\_\_\_\_\_

**RESOLUTION #092120-03**

**RESOLUTION APPROVING PAY REQUEST #5 FOR J&L  
CONSTRUCTION, LLC, FOR 4<sup>th</sup> STREET  
CONSTRUCTION PROJECT**

**Whereas**, the City of Riverside City at the recommendation of the City Engineering Firm, MMS Consultants, Scott Pottorff and it is the opinion of the City Engineering Firm that the City Council accept this pay request #5 in the amount of \$282,804.31 for payment of this project.

**Therefore**, be it resolved the City of Riverside City Council does hereby accept the Pay Request #5 for work done on the 4<sup>TH</sup> Street project from 8/12/20 to 9/15/20, with 90.56% complete.

It was moved by Councilperson \_\_\_\_\_, seconded by Councilperson \_\_\_\_\_ to approve the foregoing resolution.

**Roll Call:** Schneider, Sexton, Rogers, Redlinger, McGuire

Ayes:

Nays:

Absents:

**PASSED AND APPROVED** by City Council of Riverside, Iowa, on this 21<sup>st</sup> day of September, 2020.

Signed: \_\_\_\_\_ Date \_\_\_\_\_

Allen Schneider, Mayor

Attest: \_\_\_\_\_ Date \_\_\_\_\_

Becky LaRoche, City Clerk

# COUNCIL PACKET

## CONSTRUCTION PROGRESS PAYMENT

Project Description		PN:	2245045
Contract Date	<u>4th Street Improvements</u>		
	<u>16-Apr-20</u>		
Contractor:	<u>J&amp;L Construction</u>	Owner:	<u>City of Riverside</u>
Address:	<u>1971 Lexington Boulevard</u>	Attn:	<u></u>
City, St., Zip:	<u>Washington, IA 52353</u>	Address:	<u>60 N. Greene Street</u>
Phone:	<u>319-653-3597</u>	City, St., Zip:	<u>Riverside, IA 52327</u>
Fax:	<u>319-653-2410</u>	Phone:	<u>319-648-3501</u>
		Fax:	<u></u>

Estimate #	<input type="checkbox"/> 5		FOR PERIOD:
	<input checked="" type="checkbox"/> Partial Payment		FROM: <u>8/12/20</u>
	<input type="checkbox"/> Final Payment		TO: <u>9/15/20</u>
		Owner PN	<u></u>
		Federal PN	<u></u>
		State PN	<u></u>

Base Contract Price		\$875,061.25
Change #	1	\$442.75
Change #	2	\$4,507.00
Change #	3	\$3,500.00
Change #	4	\$2,830.00
Change #	5	\$715.00
Change #	6	\$1,088.00
Total Contract		\$888,144.00

Materials on Hand	\$	-
Construction Completed		\$804,322.00
		90.56%
Total Earned		\$804,322.00
Less Retainage		\$40,216.10
Less Previous Payment		\$481,301.59
Amount Due This Est		\$282,804.31

Requested by: \_\_\_\_\_

Jay Peiffer

Title: \_\_\_\_\_

President

Date: \_\_\_\_\_

Recommended by: \_\_\_\_\_

Scott Pottorff

Title: \_\_\_\_\_

Project Engineer

Date: \_\_\_\_\_

Approved by: \_\_\_\_\_

Title: \_\_\_\_\_

Date: \_\_\_\_\_

Attested by: \_\_\_\_\_

Title: \_\_\_\_\_

Date: \_\_\_\_\_

MMS Consultants, Inc.  
1917 South Gilbert Street, Iowa City, IA 52240

i:\proj\forms\payreqst.xls



COUNCIL PACKET

4th Street Improvements Project

5

Pay Estimate No.: J&L Construction  
 Payable to: September 15, 2020  
 Date: September 15, 2020  
 Week Ending: September 15, 2020

Item No.	Item Description	Units	Contract Quantity	Unit Price	Contract Amount	Quantity This Estimate	Amount This Estimate	To Date Quantity	To Date Amount
1	Traffic Control	LS	1	\$4,100.00	\$ 4,100.00	0.25	\$ 1,025.00	1.00	\$ 4,100.00
2	Mobilization	LS	1	\$46,500.00	\$ 46,500.00	-	-	1.00	\$ 46,500.00
3	Removal of Tree	EA	22	\$650.00	\$ 14,300.00	-	-	22.00	\$ 14,300.00
4	Removal of Shrub	EA	7	\$105.00	\$ 735.00	-	-	7.00	\$ 735.00
5	Off Site Topsoil	CY	600	\$5.00	\$ 3,000.00	400.00	\$ 2,000.00	400.00	\$ 2,000.00
6	Excavation, Class 13, Waste	CY	2370	\$19.00	\$ 45,030.00	1,095.00	\$ 20,805.00	2,370.00	\$ 45,030.00
7	Below Grade Excavation (Core Out)	CY	500	\$55.00	\$ 27,500.00	-	-	-	-
8	Subgrade Preparation	SY	5,222	\$3.25	\$ 16,971.50	839.00	\$ 2,726.75	5,222.00	\$ 16,971.50
9	Subbase, Modified, 4" Thick Rock for PCC Sidewalk & PCC Driveway **	SY	1,385	\$8.00	\$ 11,080.00	955.00	\$ 7,640.00	1,389.00	\$ 10,952.00
10	Subbase, Modified, 6" Thick Rock for PCC and HMA Paving *	SY	5,257	\$9.00	\$ 47,313.00	874.00	\$ 7,866.00	5,257.00	\$ 47,313.00
11	Backfilling of Curbs	LF	2,375	\$15.00	\$ 35,625.00	2,375.00	\$ 35,625.00	2,375.00	\$ 35,625.00
12	Granular Trench Backfill, Class A Crushed Stone, 12" Storm Sewer	LF	205	\$22.00	\$ 4,510.00	-	-	205.00	\$ 4,510.00
13	Granular Trench Backfill, Class A Crushed Stone, 15" Storm Sewer	LF	31	\$22.00	\$ 682.00	-	-	31.00	\$ 682.00
14	Granular Trench Backfill, Porous Backfill, 8" Storm Sewer	LF	88	\$25.00	\$ 2,200.00	-	-	88.00	\$ 2,200.00
15	Granular Trench Backfill, Porous Backfill, 12" Storm Sewer	LF	237	\$25.00	\$ 5,925.00	-	-	237.00	\$ 5,925.00
16	Granular Trench Backfill, Porous Backfill, 15" Storm Sewer	LF	128	\$25.00	\$ 3,200.00	-	-	128.00	\$ 3,200.00
17	Storm Sewer, Trenched, ADS N-12, 8" Dia.	LF	326	\$33.00	\$ 10,758.00	-	-	326.00	\$ 10,758.00
18	Storm Sewer, Trenched, ADS N-12, 12" Dia.	LF	250	\$36.00	\$ 9,000.00	-	-	250.00	\$ 9,000.00
19	Storm Sewer, Trenched, RCP or Polypropylene, 12" Dia.	LF	442	\$37.00	\$ 16,354.00	-	-	442.00	\$ 16,354.00
20	Storm Sewer, Trenched, RCP or Polypropylene, 15" Dia.	LF	198	\$40.00	\$ 7,960.00	-	-	199.00	\$ 7,960.00
21	Storm Sewer, Trenched, RCP or Polypropylene, 18" Dia.	LF	79	\$44.00	\$ 3,476.00	-	-	79.00	\$ 3,476.00
22	Removal of Culvert	EA	6	\$300.00	\$ 1,800.00	4.00	\$ 1,200.00	6.00	\$ 1,800.00
23	Flared End Section, RCP, 18"	EA	1	\$900.00	\$ 900.00	-	-	1.00	\$ 900.00
24	Longitudinal Subdrain, Type 2, 6"	LF	1,485	\$9.75	\$ 14,576.25	-	-	1,495.00	\$ 14,576.25
25	Subdrain Cleanout, Type A-1	EA	9	\$430.00	\$ 3,870.00	2.00	\$ 860.00	9.00	\$ 3,870.00
26	Subdrain Outlet, Connection to Structure	EA	10	\$110.00	\$ 1,100.00	10.00	\$ 1,100.00	10.00	\$ 1,100.00
27	Connect Existing Sump Pump Outlet or Downspout Drain to Storm Sewer or Subdrain	EA	3	\$250.00	\$ 750.00	1.00	\$ 250.00	3.00	\$ 750.00
28	Water Main, 6", PVC DR-18 *	LF	1,057	\$41.00	\$ 43,337.00	-	-	1,057.00	\$ 43,337.00
29	Water Main, Trenchless, 6", Restrained Joint PVC DR-18	LF	85	\$85.00	\$ 7,225.00	-	-	85.00	\$ 7,225.00
30	Install 6" x 6" Tee	EA	2	\$1,800.00	\$ 3,600.00	-	-	2.00	\$ 3,600.00
31	Remove Existing Valve and Tee and Install Sleeve	EA	1	\$2,000.00	\$ 2,000.00	-	-	1.00	\$ 2,000.00
32	Remove Existing Valve Box	EA	2	\$300.00	\$ 600.00	-	-	2.00	\$ 600.00
33	Connect to Existing Water Main	EA	1	\$1,800.00	\$ 1,800.00	-	-	1.00	\$ 1,800.00
34	Water Service, Main to Curb Stop, 1" PE 200 PSI	EA	8	\$800.00	\$ 6,400.00	-	-	8.00	\$ 6,400.00
35	Water Service, Main to Curb Stop on Opposite Side of Street, 1" PE 200 PSI	EA	8	\$1,630.00	\$ 13,040.00	-	-	9.00	\$ 14,670.00
36	Exploratory Excavation for Water Main	EA	1	\$1,800.00	\$ 1,800.00	-	-	1.00	\$ 1,800.00
37	Gate Valve, 6"	EA	3	\$950.00	\$ 2,850.00	-	-	3.00	\$ 2,850.00
38	Fire Hydrant Assembly	EA	1	\$4,050.00	\$ 4,050.00	-	-	1.00	\$ 4,050.00
39	Remove Existing Fire Hydrant Assembly	EA	1	\$300.00	\$ 300.00	-	-	1.00	\$ 300.00
40	Storm Sewer Manhole, Type SW-401, 48"	EA	1	\$4,000.00	\$ 4,000.00	-	-	1.00	\$ 4,000.00
41	Storm Intake, Type SW-509	EA	8	\$4,500.00	\$ 36,000.00	3.00	\$ 13,500.00	9.00	\$ 40,500.00
42	Storm Intake, Type SW-512, 24"	EA	7	\$1,500.00	\$ 10,500.00	-	-	7.00	\$ 10,500.00
43	Storm Intake, Type SW-541	EA	4	\$5,800.00	\$ 23,200.00	-	-	3.00	\$ 17,400.00
44	Storm Intake, Vane Drain	LF	36	\$250.00	\$ 9,000.00	36.00	\$ 9,000.00	36.00	\$ 9,000.00
45	Connect to Existing Storm Structure	EA	1	\$1,000.00	\$ 1,000.00	-	-	1.00	\$ 1,000.00
46	Removal of Storm Structure	EA	1	\$350.00	\$ 350.00	-	-	1.00	\$ 350.00

# COUNCIL PACKET

Item No.	Item Description	Units	Contract Quantity	Unit Price	Contract Amount	Quantity This Estimate	Amount This Estimate	To Date Quantity	To Date Amount
47	PCC Pavement, 7"	SY	4,420	\$43.50	\$ 192,270.00	2,295.00	\$ 99,832.50	4,420.00	\$ 192,270.00
48	Removal of Pavement	SY	128	\$11.00	\$ 1,408.00	98.00	\$ 1,078.00	128.00	\$ 1,408.00
49	HMA Pavement, 4" **	SY	262	\$53.00	\$ 13,886.00	309.00	\$ 16,377.00	309.00	\$ 16,377.00
50	Adjust Sanitary Manhole Rim	EA	2	\$385.00	\$ 770.00	2.00	\$ 770.00	2.00	\$ 770.00
51	Removal of Sidewalk	SY	917	\$15.00	\$ 13,755.00	587.00	\$ 8,805.00	917.00	\$ 13,755.00
52	Removal of Paved Driveway **	SY	89	\$9.00	\$ 801.00	53.00	\$ 477.00	73.00	\$ 657.00
53	PCC Sidewalk, 5"	SY	1051	\$51.50	\$ 54,126.50	637.00	\$ 32,805.50	1,051.00	\$ 54,126.50
54	Delectable Warnings	SF	106	\$35.00	\$ 3,710.00	96.00	\$ 3,360.00	106.00	\$ 3,710.00
55	PCC Driveway, 6" Thick **	SY	332	\$51.00	\$ 16,932.00	316.00	\$ 16,116.00	316.00	\$ 16,116.00
56	Granular Driveway Surfacing, Class A Crushed Stone	TONS	20	\$30.00	\$ 600.00	20.00	\$ 600.00	20.00	\$ 600.00
57	Sod	SQ	420	\$70.00	\$ 29,400.00	-	\$ -	-	\$ -
58	SWPPP Management	LS	1	\$1,200.00	\$ 1,200.00	-	\$ -	0.50	\$ 600.00
59	Silt Fence	LF	1400	\$1.50	\$ 2,100.00	990.00	\$ 1,485.00	990.00	\$ 1,485.00
60	Silt Fence, Clean Out Sediment	LF	1400	\$0.50	\$ 700.00	-	\$ -	-	\$ -
61	Inlet Protection Device	EA	23	\$55.00	\$ 1,265.00	7.00	\$ 385.00	18.00	\$ 990.00
62	Inlet Protection Device Maintenance	EA	23	\$25.00	\$ 575.00	-	\$ -	-	\$ -
63	Segmental Block Retaining Wall	SF	220	\$50.00	\$ 11,000.00	-	\$ -	-	\$ -
64	PCC Concrete Steps, Type A	SF	140	\$51.00	\$ 7,140.00	-	\$ -	-	\$ -
65	Remove and Reinstall Signs	EA	3	\$250.00	\$ 750.00	-	\$ -	-	\$ -
<b>TOTAL CONTRACT</b>									
					\$ 880,656.25		\$ 297,688.75		\$ 796,834.25
C.O. #1	Trim Tree Branches at 311 E. 4th Street	LS	1,000	\$442.75	\$ 442,750.00	-	\$ -	1,000	\$ 442,750.00
<b>TOTAL CHANGE C.O. #1</b>									
					\$ 442,750.00		\$ -		\$ 442,750.00
C.O. #3	Storm Intake, Type SW-507	EA	1,000	\$3,500.00	\$ 3,500.00	-	\$ -	1,000	\$ 3,500.00
<b>TOTAL CHANGE C.O. #3</b>									
					\$ 3,500.00		\$ -		\$ 3,500.00
C.O. #4	Lower Sanitary Service at 316 E. 4th Street	LS	1,000	\$1,850.00	\$ 1,850.00	-	\$ -	1,000	\$ 1,850.00
	Lower Sanitary Service at 241 E. 4th Street	LS	1,000	\$980.00	\$ 980.00	-	\$ -	1,000	\$ 980.00
<b>TOTAL CHANGE C.O. #4</b>									
					\$ 2,830.00		\$ -		\$ 2,830.00
C.O. #5	Granular Trench Backfill	TON	65,000	\$11.00	\$ 715,000.00	-	\$ -	65,000	\$ 715,000.00
<b>TOTAL CHANGE C.O. #5</b>									
					\$ 715,000.00		\$ -		\$ 715,000.00
<b>TOTAL CONTRACT WITH CHANGE ORDERS</b>									
					\$ 888,144.00		\$ 297,688.75		\$ 804,322.00

\* Quantity Changed with Change Order #2  
 \*\* Quantity Changed with Change Order #6

Pay Estimate #1  
 Pay Estimate #2  
 Pay Estimate #3  
 Pay Estimate #4

Retainage 5% \$ 40,216.10

Total Value of Completed Work Less Retainage \$ 764,105.90

Previous Payments \$ 481,301.59  
 Current Payment Due \$ 282,804.31

# COUNCIL PACKET

## City Admin

---

**From:** Scott Pottorff <S.pottorff@mmsconsultants.net>  
**Sent:** Wednesday, September 16, 2020 8:22 AM  
**To:** admin@cityofriversideiowa.com  
**Subject:** Potential Extras for Safe Routes to Schools

We had discussed some potential extras on the Safe Routes to School project. I wanted to summarize them here for discussion at the Council meeting Monday night.

There was a total of 480 CY of topsoil and per the plans the same amount of excavation (dirt was hauled off to make room for the topsoil). Plan quantity for both is 400 CY. The unit prices and extra costs would be as follows:

Excavation	80 CY	\$40.00/CY	\$3,200.00
Topsoil	80 CY	\$53.00/CY	\$4,240.00

There may be extra sod as well. Craig is tying down the area of the sod today so will have info on this later today or tomorrow. They have claimed 108 SQ extra of sod above the plan quantity although we are pretty certain it is not that much. Unit price for sod is \$70/SQ so if they are correct it could be as much as \$7,560 extra on sod. Again we don't think it is that much but will have more information on this later this week and in time of the Council meeting for sure.

I wanted to get the cost impact information to you so it could be included in the packet for the meeting.

Let me know if you have questions.



**Scott Pottorff, P.E.**

*Project Manager*

Ofc: (319) 351-8282

Direct: (319) 339-4153

Cell: (319) 631-0365

[S.pottorff@mmsconsultants.net](mailto:S.pottorff@mmsconsultants.net)

[mmsconsultants.net](http://mmsconsultants.net)

*This email message is for the sole use of the intended recipient(s) and may contain confidential and privileged information. Any unauthorized review, use, disclosure or distribution is prohibited. If you are not the intended recipient, please contact the sender by reply email and destroy all copies of the original message.*

COUNCIL PACKET

**RESOLUTION #092120-04**

**RESOLUTION TO APPROVE THE DONATION OF USED AMBULANCE**

**WHEREAS**, as the City of Riverside EMS/Fire Department is looking to replace two EMS vehicles with one quick response unit, the Department seeks to donate the used ambulance to Washington County Ambulance Service.

**THEREFORE, BE IT RESOLVED**, the City of Riverside City Council, hereby approves the donation of the 2002 Ford Medtec Ambulance to Washington County Ambulance Service.

It was moved by Councilperson \_\_\_\_\_, seconded by Councilperson \_\_\_\_\_, to adopt the foregoing resolution.

Roll Call: Sexton, Redlinger, Rodgers, McGuire, Schneider

Ayes: :

Nays:

Absents:

**PASSED AND APPROVED** by city Council of Riverside, Iowa, on this 21<sup>ST</sup> day of September, 2020.

Signed: \_\_\_\_\_ Date: \_\_\_\_\_

Allen Schneider, Mayor

Attest: \_\_\_\_\_ Date: \_\_\_\_\_

Becky LaRoche, City Clerk

COUNCIL PACKET

RESOLUTION #092120-05

RESOLUTION ACCEPTING PURCHASE AGREEMENT FOR A NEW EMS TRUCK

WHEREAS, City Council of Riverside acknowledges the need for a new Quick Response/EMS vehicle,

WHEREAS, The City of Riverside, IA agrees to purchase a \_\_\_\_\_ truck from \_\_\_\_\_ at the price of \_\_\_\_\_.

WHEREAS, Riverside Emergency Services Association (RESA) will purchase the topper, slide out, graphics, and vehicle accessories at a cost of \$15,000,

THEREFORE, BE IT RESOLVED, the City of Riverside, hereby approves the \_\_\_\_\_ truck purchase for the amount of \_\_\_\_\_.

It was moved by Councilperson \_\_\_\_\_, seconded by Councilperson \_\_\_\_\_ to adopt the foregoing resolution.

Roll Call Vote: Sexton, Redlinger, Rodgers, McGuire, Schneider

AYES:

NAYS:

ABSENT:

PASSED AND APPROVED by the City Council of Riverside, Iowa, on this 21<sup>st</sup> day of September, 2020.

SIGNED: \_\_\_\_\_ Date: \_\_\_\_\_  
Allen Schneider, Mayor

ATTEST: \_\_\_\_\_ Date: \_\_\_\_\_  
Becky LaRoche, City Clerk

## COUNCIL PACKET

### City Admin

---

**From:** Chad Smothers <chadsmothers.cs@gmail.com>  
**Sent:** Thursday, September 10, 2020 8:43 AM  
**To:** City Admin; Mayor  
**Subject:** RFD New Pickup

I am providing some information and pictures of what the pickup for RFD would look like. We got bids on Chevy and Dodge trucks. The Dodge is no longer available and the new ones won't be available until March of 2021. The Chevy would have a 6-8 week build time and would be a 2021 model. We would like to have this vehicle up and going before winter so my recommendation is the Chevy. I provided the bids to Christine for everyone to see the price. The money for this truck will come from our equipment replacement account which has been built up over the several years of money not spent out of our yearly budget. The following is estimates of cost and where the money would come from. I plan to attend the council meeting on the 21st to ask for approval of truck purchase. This vehicle will work for our EMS, Grain Bin & Water Rescue equipment. I know we had \$300,000 budgeted for an ambulance but we all know that idea is on hold. I would like to see us keep that money available for an ambulance or another future vehicle. This vehicle can be used in multiple areas and could replace our suburban also. If you have questions let me know.



COUNCIL PACKET



Truck \$34,000 equipment replacement account  
Warning lights & siren \$10,000 equipment replacement account

## COUNCIL PACKET

Topper, Slide Out, Graphics and Vehicle accessories \$15,000 RESA

Thanks  
Chief Smothers





FROM: Coppers - Washington  
 COUNCIL PACKET

Vehicle: [Fleet] 2020 Ram 3500 (D28L91) Tradesman 4x4 Crew Cab 6'4" Box (✔ Complete)

Quote Worksheet 2020 - Not AVAILABLE

	MSRP
Base Price	\$41,700.00
Dest Charge	\$1,695.00
Total Options	\$1,785.00
	<b>Subtotal</b>
	<b>\$45,180.00</b>
User Item	\$0.00
	<b>Subtotal Pre-Tax Adjustments</b>
	<b>\$0.00</b>
Less Customer Discount	(\$15,035.00)
	<b>Subtotal Discount</b>
	<b>(\$15,035.00)</b>
Trade-In	\$0.00
	<b>Subtotal Trade-In</b>
	<b>\$0.00</b>
	<b>Taxable Price</b>
	<b>\$30,145.00</b>
Sales Tax	\$0.00
	<b>Subtotal Taxes</b>
	<b>\$0.00</b>
	<b>Subtotal Post-Tax Adjustments</b>
	<b>\$0.00</b>
	<b>Total Sales Price</b>
	<b>\$30,145.00</b>

Dealer Signature / Date

Customer Signature / Date

2020  
 This vehicle No longer Available

2021 would be March 2021

This document contains information considered Confidential between GM and its Clients uniquely. The information provided is not intended for public disclosure. Prices, specifications, and availability are subject to change without notice, and do not include certain fees, taxes and charges that may be required by law or vary by manufacturer or region. Performance figures are guidelines only, and actual performance may vary. Photos may not represent actual vehicles or exact configurations. Content based on report preparer's input is subject to the accuracy of the input provided.

Data Version: 11619. Data Updated: Aug 11, 2020 10:29:00 PM PDT.



COUNCIL PACKET

Vehicle: [Fleet] 2020 Ram 3500 (D28L91) Tradesman 4x4 Crew Cab 6'4" Box (✔ Complete)

Selected Model and Options

MODEL

CODE	MODEL	MSRP
D28L91	2020 Ram 3500 Tradesman 4x4 Crew Cab 6'4" Box	\$41,700.00

COLORS

CODE	DESCRIPTION	MSRP
P12	Bright Red	\$450.00

ENGINE

CODE	DESCRIPTION	FRONT WEIGHT	REAR WEIGHT	MSRP
ESA	Engine: 6.4L Heavy Duty V8 HEMI w/MDS (STD)	0.00 lbs	0.00 lbs	\$0.00

TRANSMISSION

CODE	DESCRIPTION	FRONT WEIGHT	REAR WEIGHT	MSRP
DFX	Transmission: 8-Speed Auto (8HP75-LCV) (STD)	0.00 lbs	0.00 lbs	\$0.00

CPOS PKG

CODE	DESCRIPTION	FRONT WEIGHT	REAR WEIGHT	MSRP
2ZA	Quick Order Package 2ZA Tradesman -inc: Engine: 6.4L Heavy Duty V8 HEMI w/MDS, Transmission: 8-Speed Auto (8HP75-LCV)	0.00 lbs	0.00 lbs	\$0.00

AXLE RATIO

CODE	DESCRIPTION	FRONT WEIGHT	REAR WEIGHT	MSRP
DME	3.73 Axle Ratio (STD)	0.00 lbs	0.00 lbs	\$0.00

WHEELS

CODE	DESCRIPTION	FRONT WEIGHT	REAR WEIGHT	MSRP
WBN	Wheels: 18" x 8.0" Steel (STD)	0.00 lbs	0.00 lbs	\$0.00

This document contains information considered Confidential between GM and its Clients uniquely. The information provided is not intended for public disclosure. Prices, specifications, and availability are subject to change without notice, and do not include certain fees, taxes and charges that may be required by law or vary by manufacturer or region. Performance figures are guidelines only, and actual performance may vary. Photos may not represent actual vehicles or exact configurations. Content based on report preparer's input is subject to the accuracy of the input provided.

Data Version: 11619. Data Updated: Aug 11, 2020 10:29:00 PM PDT.



COUNCIL PACKET

Vehicle: [Fleet] 2020 Ram 3500 (D28L91) Tradesman 4x4 Crew Cab 6'4" Box ( Complete )

TIRES

CODE	DESCRIPTION	FRONT WEIGHT	REAR WEIGHT	MSRP
TCN	Tires: LT275/70R18E BSW AS (STD)	0.00 lbs	0.00 lbs	\$0.00

PRIMARY PAINT

CODE	DESCRIPTION	FRONT WEIGHT	REAR WEIGHT	MSRP
P12	Bright Red	0.00 lbs	0.00 lbs	\$450.00

SEAT TYPE

CODE	DESCRIPTION	FRONT WEIGHT	REAR WEIGHT	MSRP
TXX8	Diesel Gray/Black, HD Vinyl 40/20/40 Split Bench Seat	0.00 lbs	0.00 lbs	\$0.00

GVWR

CODE	DESCRIPTION	FRONT WEIGHT	REAR WEIGHT	MSRP
Z8F	GVWR: 11,000 lbs (STD)	0.00 lbs	0.00 lbs	\$0.00

ADDITIONAL EQUIPMENT - PACKAGE

CODE	DESCRIPTION	FRONT WEIGHT	REAR WEIGHT	MSRP
AH6	Emergency/Fire/Rescue Special Service Package -inc: Upfitter Electronic Module (VSIM), Tow Hooks	0.00 lbs	0.00 lbs	\$745.00

ADDITIONAL EQUIPMENT - MECHANICAL

CODE	DESCRIPTION	FRONT WEIGHT	REAR WEIGHT	MSRP
BAJ	220 Amp Alternator	0.00 lbs	0.00 lbs	Inc.
DK3	Electric Shift-On-The-Fly Transfer Case	0.00 lbs	0.00 lbs	\$295.00
XHC	Trailer Brake Control	0.00 lbs	0.00 lbs	\$295.00

This document contains information considered Confidential between GM and its Clients uniquely. The information provided is not intended for public disclosure. Prices, specifications, and availability are subject to change without notice, and do not include certain fees, taxes and charges that may be required by law or vary by manufacturer or region. Performance figures are guidelines only, and actual performance may vary. Photos may not represent actual vehicles or exact configurations. Content based on report preparer's input is subject to the accuracy of the input provided.

Data Version: 11619. Data Updated: Aug 11, 2020 10:29:00 PM PDT.



Vehicle: [Fleet] 2020 Ram 3500 (D28L91) Tradesman 4x4 Crew Cab 6'4" Box (  Complete )

**ADDITIONAL EQUIPMENT - INTERIOR**

CODE	DESCRIPTION	FRONT WEIGHT	REAR WEIGHT	MSRP
LHL	I/P Mounted Auxilliary Switches	0.00 lbs	0.00 lbs	Inc.
XXS	Upfitter Electronic Module (VSIM)	0.00 lbs	0.00 lbs	Inc.
<b>Options Total</b>		<b>0.00 lbs</b>	<b>0.00 lbs</b>	<b>\$1,785.00</b>

This document contains information considered Confidential between GM and its Clients uniquely. The information provided is not intended for public disclosure. Prices, specifications, and availability are subject to change without notice, and do not include certain fees, taxes and charges that may be required by law or vary by manufacturer or region. Performance figures are guidelines only, and actual performance may vary. Photos may not represent actual vehicles or exact configurations. Content based on report preparer's input is subject to the accuracy of the input provided.  
 Data Version: 11619. Data Updated: Aug 11, 2020 10:29:00 PM PDT.



Vehicle: [Fleet] 2020 Ram 3500 (D28L91) Tradesman 4x4 Crew Cab 6'4" Box (✔ Complete)

## Standard Equipment

### Mechanical

Engine: 6.4L Heavy Duty V8 HEMI w/MDS (STD)  
Transmission: 8-Speed Auto (8HP75-LCV) (STD)  
3.73 Axle Ratio (STD)  
GVWR: 11,000 lbs (STD)  
50 State Emissions  
Transmission w/Driver Selectable Mode and Sequential Shift Control  
Manual Transfer Case  
Part-Time Four-Wheel Drive  
730CCA Maintenance-Free Battery w/Run Down Protection  
180 Amp Alternator  
Electronically Controlled Throttle  
Tip Start  
Class V Towing Equipment -inc: Hitch and Trailer Sway Control  
Trailer Wiring Harness  
4240# Maximum Payload  
HD Shock Absorbers  
Front Anti-Roll Bar  
Hydraulic Power-Assist Steering  
Single Stainless Steel Exhaust  
31 Gal. Fuel Tank  
Auto Locking Hubs  
Multi-Link Front Suspension w/Coll Springs  
Leaf Rear Suspension w/Leaf Springs  
4-Wheel Disc Brakes w/4-Wheel ABS, Front And Rear Vented Discs, Brake Assist and Hill Hold Control  
Mechanical Limited Slip Differential

### Exterior

Wheels: 18" x 8.0" Steel (STD)  
Tires: LT275/70R18E BSW AS (STD)  
Regular Box Style

This document contains information considered Confidential between GM and its Clients uniquely. The information provided is not intended for public disclosure. Prices, specifications, and availability are subject to change without notice, and do not include certain fees, taxes and charges that may be required by law or vary by manufacturer or region. Performance figures are guidelines only, and actual performance may vary. Photos may not represent actual vehicles or exact configurations. Content based on report preparer's input is subject to the accuracy of the input provided.

Data Version: 11619. Data Updated: Aug 11, 2020 10:29:00 PM PDT.



## COUNCIL PACKET

Vehicle: [Fleet] 2020 Ram 3500 (D28L91) Tradesman 4x4 Crew Cab 6'4" Box (✔ Complete)

### Exterior

- Steel Spare Wheel
- Full-Size Spare Tire Stored Underbody w/Crankdown
- Clearcoat Paint
- Black Rear Step Bumper
- Black Front Bumper w/2 Tow Hooks
- Front Bumper Sight Shields
- Black Side Windows Trim and Black Front Windshield Trim
- Black Door Handles
- Manual Extendable Trailer Style Mirrors
- Black Power Heated Side Mirrors w/Convex Spotter, Manual Folding, Turn Signal Indicator and Clearance Lights
- Fixed Rear Window
- Variable Intermittent Wipers
- Deep Tinted Glass
- Galvanized Steel/Aluminum Panels
- Black Grille
- Front License Plate Bracket
- Tailgate Rear Cargo Access
- Manual Tailgate/Rear Door Lock
- Fully Automatic Aero-Composite Halogen Daytime Running Headlamps w/Delay-Off
- Cargo Lamp w/High Mount Stop Light
- Perimeter/Approach Lights

### Entertainment

- Radio w/Seek-Scan, Clock, Aux Audio Input Jack, Voice Activation, Radio Data System and External Memory Control
- Radio: Uconnect 3 w/5" Display
- Streaming Audio
- Integrated Roof Antenna
- 6 Speakers
- GPS Antenna Input
- Active Noise Control System

This document contains information considered Confidential between GM and its Clients uniquely. The information provided is not intended for public disclosure. Prices, specifications, and availability are subject to change without notice, and do not include certain fees, taxes and charges that may be required by law or vary by manufacturer or region. Performance figures are guidelines only, and actual performance may vary. Photos may not represent actual vehicles or exact configurations. Content based on report preparer's input is subject to the accuracy of the input provided.

Data Version: 11619. Data Updated: Aug 11, 2020 10:29:00 PM PDT.



Vehicle: [Fleet] 2020 Ram 3500 (D28L91) Tradesman 4x4 Crew Cab 6'4" Box (✓ Complete)

**Entertainment**

- USB Host Flip
- 1 LCD Monitor In The Front

**Interior**

- Driver Seat
- Manual Adjust 4-Way Driver Seat
- Passenger Seat
- Manual Adjust 4-Way Front Passenger Seat
- Front Facing Vinyl Rear Seat
- Manual Tilt Steering Column
- Gauges -inc: Speedometer, Odometer, Voltmeter, Oil Pressure, Engine Coolant Temp, Tachometer, Oil Temperature, Transmission Fluid Temp, Engine Hour Meter and Trip Odometer
- Power Rear Windows
- Rear Folding Seat
- Rear Cupholder
- Compass
- Proximity Key For Push Button Start Only
- Cruise Control w/Steering Wheel Controls
- Manual Air Conditioning
- HVAC -inc: Underseat Ducts and Console Ducts
- Glove Box
- Interior Trim -inc: Metal-Look Instrument Panel Insert and Chrome/Metal-Look Interior Accents
- Full Cloth Headliner
- Urethane Gear Shifter Material
- HD Vinyl 40/20/40 Split Bench Seat
- Day-Night Rearview Mirror
- Passenger Visor Vanity Mirror
- 2 12V DC Power Outlets
- Partial Floor Console w/Storage, Mini Overhead Console and 2 12V DC Power Outlets
- Front Map Lights
- Fade-To-Off Interior Lighting

This document contains information considered Confidential between GM and its Clients uniquely. The information provided is not intended for public disclosure. Prices, specifications, and availability are subject to change without notice, and do not include certain fees, taxes and charges that may be required by law or vary by manufacturer or region. Performance figures are guidelines only, and actual performance may vary. Photos may not represent actual vehicles or exact configurations. Content based on report preparer's input is subject to the accuracy of the input provided.

Data Version: 11619. Data Updated: Aug 11, 2020 10:29:00 PM PDT.



Vehicle: [Fleet] 2020 Ram 3500 (D28L91) Tradesman 4x4 Crew Cab 6'4" Box (✔ Complete)

**Interior**

- Full Vinyl/Rubber Floor Covering
- Pickup Cargo Box Lights
- Integrated Voice Command w/Bluetooth
- Instrument Panel Bin, Dashboard Storage, Driver / Passenger And Rear Door Bins and 2nd Row Underseat Storage
- Delayed Accessory Power
- Power Door Locks w/Autolock Feature
- Power 1st Row Windows w/Driver And Passenger 1-Touch Up/Down
- Systems Monitor
- Outside Temp Gauge
- Analog Display
- Seats w/Vinyl Back Material
- Armrests w/Storage
- 40/20/40 Split Bench Seat
- Front Armrest w/Cupholders
- 4 Way Front Headrests
- 2 Way Rear Headrest Seat
- Sentry Key Engine Immobilizer

**Safety-Mechanical**

- Electronic Stability Control (ESC) And Roll Stability Control (RSC)
- ABS And Driveline Traction Control

**Safety-Exterior**

- Side Impact Beams

**Safety-Interior**

- Dual Stage Driver And Passenger Seat-Mounted Side Airbags
- Tire Specific Low Tire Pressure Warning
- Dual Stage Driver And Passenger Front Airbags
- Airbag Occupancy Sensor
- Curtain 1st And 2nd Row Airbags
- Rear Child Safety Locks

This document contains information considered Confidential between GM and its Clients uniquely. The information provided is not intended for public disclosure. Prices, specifications, and availability are subject to change without notice, and do not include certain fees, taxes and charges that may be required by law or vary by manufacturer or region. Performance figures are guidelines only, and actual performance may vary. Photos may not represent actual vehicles or exact configurations. Content based on report preparer's input is subject to the accuracy of the input provided.

Data Version: 11619. Data Updated: Aug 11, 2020 10:29:00 PM PDT.





Vehicle: [Fleet] 2020 Ram 3500 (D28L91) Tradesman 4x4 Crew Cab 6'4" Box (✔ Complete)

**Safety-Interior**

Outboard Front Lap And Shoulder Safety Belts -inc: Rear Center 3 Point, Height Adjusters and Pretensioners

ParkView Back-Up Camera

**WARRANTY**

Basic Years: 3  
Basic Miles/km: 36,000  
Drivetrain Years: 5  
Drivetrain Miles/km: 60,000  
Corrosion Years: 5  
Corrosion Miles/km: 100,000  
Roadside Assistance Years: 5  
Roadside Assistance Miles/km: 100,000

This document contains information considered Confidential between GM and its Clients uniquely. The information provided is not intended for public disclosure. Prices, specifications, and availability are subject to change without notice, and do not include certain fees, taxes and charges that may be required by law or vary by manufacturer or region. Performance figures are guidelines only, and actual performance may vary. Photos may not represent actual vehicles or exact configurations. Content based on report preparer's input is subject to the accuracy of the input provided.

Data Version: 11619. Data Updated: Aug 11, 2020 10:29:00 PM PDT.



COUNCIL PACKET

Vehicle: [Fleet] 2020 Ram 3500 (D28L91) Tradesman 4x4 Crew Cab 6'4" Box (✔ Complete)

Window Sticker

SUMMARY

[Fleet] 2020 Ram 3500 (D28L91) Tradesman 4x4 Crew Cab 6'4" Box

MSRP:\$41,700.00

Interior:Diesel Gray/Black, HD Vinyl 40/20/40 Split Bench Seat

Exterior 1:Bright Red

Exterior 2:No color has been selected.

Engine: 6.4L Heavy Duty V8 HEMI w/MDS

Transmission: 8-Speed Auto (8HP75-LCV)

OPTIONS

CODE	MODEL	MSRP
D28L91	[Fleet] 2020 Ram 3500 (D28L91) Tradesman 4x4 Crew Cab 6'4" Box	\$41,700.00
<b>OPTIONS</b>		
2ZA	Quick Order Package 2ZA Tradesman	\$0.00
AH6	Emergency/Fire/Rescue Special Service Package	\$745.00
BAJ	220 Amp Alternator	Inc.
DFX	Transmission: 8-Speed Auto (8HP75-LCV)	\$0.00
DK3	Electric Shift-On-The-Fly Transfer Case	\$295.00
DME	3.73 Axle Ratio	\$0.00
ESA	Engine: 6.4L Heavy Duty V8 HEMI w/MDS	\$0.00
LHL	I/P Mounted Auxilliary Switches	Inc.
P12	Bright Red	\$450.00
TCN	Tires: LT275/70R18E BSW AS	\$0.00
TXX8	Diesel Gray/Black, HD Vinyl 40/20/40 Split Bench Seat	\$0.00
WBN	Wheels: 18" x 8.0" Steel	\$0.00
XHC	Trailer Brake Control	\$295.00
XXS	Upfitter Electronic Module (VSIM)	Inc.
Z8F	GVWR: 11,000 lbs	\$0.00

<b>SUBTOTAL</b>	<b>\$43,485.00</b>
Adjustments Total	\$0.00
Destination Charge	\$1,695.00

This document contains information considered Confidential between GM and its Clients uniquely. The information provided is not intended for public disclosure. Prices, specifications, and availability are subject to change without notice, and do not include certain fees, taxes and charges that may be required by law or vary by manufacturer or region. Performance figures are guidelines only, and actual performance may vary. Photos may not represent actual vehicles or exact configurations. Content based on report preparer's input is subject to the accuracy of the input provided.

Data Version: 11619. Data Updated: Aug 11, 2020 10:29:00 PM PDT.



Vehicle: [Fleet] 2020 Ram 3500 (D28L91) Tradesman 4x4 Crew Cab 6'4" Box (✔ Complete)

**TOTAL PRICE**

**\$45,180.00**

**FUEL ECONOMY**

Est City:N/A

Est Highway:N/A

Est Highway Cruising Range:N/A

This document contains information considered Confidential between GM and its Clients uniquely. The information provided is not intended for public disclosure. Prices, specifications, and availability are subject to change without notice, and do not include certain fees, taxes and charges that may be required by law or vary by manufacturer or region. Performance figures are guidelines only, and actual performance may vary. Photos may not represent actual vehicles or exact configurations. Content based on report preparer's input is subject to the accuracy of the input provided.  
Data Version: 11619. Data Updated: Aug 11, 2020 10:29:00 PM PDT.



FROM:  
WIELE Motor Co.  
Columbus Jct.

Vehicle: [Fleet] 2021 Chevrolet Silverado 3500HD (CK30943) 4WD Crew Cab 172" Work Truck



this one is 34700 i said 2021 because they are done making 2020 for fleet

6-8 weeks delivery



Vehicle: [Fleet] 2021 Chevrolet Silverado 3500HD (CK30943) 4WD Crew Cab 172" Work Truck ( Complete )

### Price Summary

#### PRICE SUMMARY

	MSRP
Base Price	\$43,100.00
Total Options	\$760.00
Vehicle Subtotal	\$43,860.00
Destination Charge	\$1,595.00
<b>Grand Total</b>	<b>\$45,455.00</b>

This document contains information considered Confidential between GM and its Clients uniquely. The information provided is not intended for public disclosure. Prices, specifications, and availability are subject to change without notice, and do not include certain fees, taxes and charges that may be required by law or vary by manufacturer or region. Performance figures are guidelines only, and actual performance may vary. Photos may not represent actual vehicles or exact configurations. Content based on report preparer's input is subject to the accuracy of the input provided.  
Data Version: 11289. Data Updated: Jun 28, 2020 9:51:00 PM PDT.



Vehicle: [Fleet] 2021 Chevrolet Silverado 3500HD (CK30943) 4WD Crew Cab 172" Work Truck ( Complete )

### Weight Ratings

#### WEIGHT RATINGS

Front Gross Axle Weight Rating:	5200 lbs
Rear Gross Axle Weight Rating:	7250 lbs
Gross Vehicle Weight Rating:	11500.00 lbs

This document contains information considered Confidential between GM and its Clients uniquely. The information provided is not intended for public disclosure. Prices, specifications, and availability are subject to change without notice, and do not include certain fees, taxes and charges that may be required by law or vary by manufacturer or region. Performance figures are guidelines only, and actual performance may vary. Photos may not represent actual vehicles or exact configurations. Content based on report preparer's input is subject to the accuracy of the input provided.

Data Version: 11289. Data Updated: Jun 28, 2020 9:51:00 PM PDT.



COUNCIL PACKET

Vehicle: [Fleet] 2021 Chevrolet Silverado 3500HD (CK30943) 4WD Crew Cab 172" Work Truck ( Complete )

Selected Model and Options

MODEL

CODE	MODEL	MSRP
CK30943	2021 Chevrolet Silverado 3500HD 4WD Crew Cab 172" Work Truck	\$43,100.00

COLORS

CODE	DESCRIPTION	MSRP
G7C	Red Hot	\$0.00

BODY CODE

CODE	DESCRIPTION	FRONT WEIGHT	REAR WEIGHT	MSRP
E63	Durabed, pickup bed (STD)	0.00 lbs	0.00 lbs	\$0.00

REAR WHEEL CONFIGURATION

CODE	DESCRIPTION	FRONT WEIGHT	REAR WEIGHT	MSRP
SRW	Single Rear Wheels (STD)	0.00 lbs	0.00 lbs	\$0.00

EMISSIONS

CODE	DESCRIPTION	FRONT WEIGHT	REAR WEIGHT	MSRP
FE9	Emissions, Federal requirements	0.00 lbs	0.00 lbs	\$0.00

ENGINE

CODE	DESCRIPTION	FRONT WEIGHT	REAR WEIGHT	MSRP
L8T	Engine, 6.6L V8 with Direct Injection and Variable Valve Timing, gasoline (401 hp [299 kW] @ 5200 rpm, 464 lb-ft of torque [629 N-m] @ 4000 rpm) (STD)	0.00 lbs	0.00 lbs	\$0.00

TRANSMISSION

CODE	DESCRIPTION	FRONT WEIGHT	REAR WEIGHT	MSRP
MYD	Transmission, 6-speed automatic, heavy-duty (STD) (Requires (L8T) 6.6L V8 gas engine.)	0.00 lbs	0.00 lbs	\$0.00

This document contains information considered Confidential between GM and its Clients uniquely. The information provided is not intended for public disclosure. Prices, specifications, and availability are subject to change without notice, and do not include certain fees, taxes and charges that may be required by law or vary by manufacturer or region. Performance figures are guidelines only, and actual performance may vary. Photos may not represent actual vehicles or exact configurations. Content based on report preparer's input is subject to the accuracy of the input provided.

Data Version: 11289. Data Updated: Jun 28, 2020 9:51:00 PM PDT.



COUNCIL PACKET

Vehicle: [Fleet] 2021 Chevrolet Silverado 3500HD (CK30943) 4WD Crew Cab 172" Work Truck ( Complete )

**GVWR**

CODE	DESCRIPTION	FRONT WEIGHT	REAR WEIGHT	MSRP
G1Y	GVWR, 11,500 lbs. (5216 kg) with single rear wheels (STD) (Included and only available with model CK30943 model and (L8T) 6.6L V8 gas engine or CC30903 and (L5P) Duramax 6.6L Turbo-Diesel V8 engine. Requires single rear wheels.)	0.00 lbs	0.00 lbs	Inc.

**AXLE**

CODE	DESCRIPTION	FRONT WEIGHT	REAR WEIGHT	MSRP
GT4	Rear axle, 3.73 ratio (Requires (L8T) 6.6L V8 gas engine. Not available with (L5P) Duramax 6.6L Turbo-Diesel V8 engine.)	0.00 lbs	0.00 lbs	\$0.00

**PREFERRED EQUIPMENT GROUP**

CODE	DESCRIPTION	FRONT WEIGHT	REAR WEIGHT	MSRP
1WT	Work Truck Preferred Equipment Group includes standard equipment	0.00 lbs	0.00 lbs	\$0.00

**WHEELS**

CODE	DESCRIPTION	FRONT WEIGHT	REAR WEIGHT	MSRP
PYT	Wheels, 18" (45.7 cm) painted steel (STD) (Requires single rear wheels.)	0.00 lbs	0.00 lbs	\$0.00

**TIRES**

CODE	DESCRIPTION	FRONT WEIGHT	REAR WEIGHT	MSRP
QF6	Tires, LT275/70R18E all-terrain, blackwall (STD) (Requires single rear wheels.)	0.00 lbs	0.00 lbs	\$0.00

This document contains information considered Confidential between GM and its Clients uniquely. The information provided is not intended for public disclosure. Prices, specifications, and availability are subject to change without notice, and do not include certain fees, taxes and charges that may be required by law or vary by manufacturer or region. Performance figures are guidelines only, and actual performance may vary. Photos may not represent actual vehicles or exact configurations. Content based on report preparer's input is subject to the accuracy of the input provided.  
 Data Version: 11289. Data Updated: Jun 28, 2020 9:51:00 PM PDT.





COUNCIL PACKET

Vehicle: [Fleet] 2021 Chevrolet Silverado 3500HD (CK30943) 4WD Crew Cab 172" Work Truck ( Complete )

SPARE TIRE

CODE	DESCRIPTION	FRONT WEIGHT	REAR WEIGHT	MSRP
ZYG	Tire, spare LT275/70R18 all-terrain, blackwall (STD) (Included and only available with (QF6) LT275/70R18E all-terrain, blackwall tires with (E63) Durabed, pickup bed single rear wheel models. Available to order when (ZW9) pickup bed delete and (QF6) LT275/70R18E all-terrain, blackwall tires are ordered with single rear wheel models)	0.00 lbs	0.00 lbs	\$0.00

PAINT

CODE	DESCRIPTION	FRONT WEIGHT	REAR WEIGHT	MSRP
G7C	Red Hot	0.00 lbs	0.00 lbs	\$0.00

SEAT TYPE

CODE	DESCRIPTION	FRONT WEIGHT	REAR WEIGHT	MSRP
AE7	Seats, front 40/20/40 split-bench with upper covered armrest storage (STD)	0.00 lbs	0.00 lbs	\$0.00

SEAT TRIM

CODE	DESCRIPTION	FRONT WEIGHT	REAR WEIGHT	MSRP
H2G	Jet Black, Vinyl seat trim	0.00 lbs	0.00 lbs	\$0.00

RADIO

CODE	DESCRIPTION	FRONT WEIGHT	REAR WEIGHT	MSRP
IOR	Audio system, Chevrolet Infotainment 3 system, 7" diagonal color touchscreen, AM/FM stereo. Additional features for compatible phones include: Bluetooth audio streaming for 2 active devices, voice command pass-through to phone, wired Apple CarPlay and Android Auto capable. (STD)	0.00 lbs	0.00 lbs	\$0.00

This document contains information considered Confidential between GM and its Clients uniquely. The information provided is not intended for public disclosure. Prices, specifications, and availability are subject to change without notice, and do not include certain fees, taxes and charges that may be required by law or vary by manufacturer or region. Performance figures are guidelines only, and actual performance may vary. Photos may not represent actual vehicles or exact configurations. Content based on report preparer's input is subject to the accuracy of the input provided.

Data Version: 11289. Data Updated: Jun 28, 2020 9:51:00 PM PDT.



COUNCIL PACKET

Vehicle: [Fleet] 2021 Chevrolet Silverado 3500HD (CK30943) 4WD Crew Cab 172" Work Truck ( Complete )

ADDITIONAL EQUIPMENT - PACKAGE

CODE	DESCRIPTION	FRONT WEIGHT	REAR WEIGHT	MSRP
ZLQ	WT Fleet Convenience Package includes (AQQ) Remote Keyless Entry, (K34) Cruise Control, (QT5) EZ Lift power lock and release tailgate and (DBG) outside power-adjustable vertical trairling with heated upper glass (Not available with (PCV) WT Convenience Package.	0.00 lbs	0.00 lbs	\$760.00

ADDITIONAL EQUIPMENT - EXTERIOR

CODE	DESCRIPTION	FRONT WEIGHT	REAR WEIGHT	MSRP
DBG	Mirrors, outside power-adjustable vertical trairling with heated upper glass lower convex mirrors, integrated turn signals, manual folding/extending (extends 3.31" [84.25mm]) (Included and only available with (ZLQ) WT Fleet Convenience Package or (PCV) WT Convenience Package.)	0.00 lbs	0.00 lbs	Inc.
QT5	Tailgate, gate function manual with EZ Lift includes power lock and release	0.00 lbs	0.00 lbs	Inc.

ADDITIONAL EQUIPMENT - INTERIOR

CODE	DESCRIPTION	FRONT WEIGHT	REAR WEIGHT	MSRP
AQQ	Remote Keyless Entry with 2 transmitters (Included and only available with (ZLQ) WT Fleet Convenience Package or (PCV) WT Convenience Package.)	0.00 lbs	0.00 lbs	Inc.
K34	Cruise control, electronic with set and resume speed, steering wheel-mounted (Included with (ZLQ) WT Fleet Convenience Package, (PCV) WT Convenience Package or (RGE) Safety Essentials Package.)	0.00 lbs	0.00 lbs	Inc.
<b>Options Total</b>		<b>0.00 lbs</b>	<b>0.00 lbs</b>	<b>\$760.00</b>

This document contains information considered Confidential between GM and its Clients uniquely. The information provided is not intended for public disclosure. Prices, specifications, and availability are subject to change without notice, and do not include certain fees, taxes and charges that may be required by law or vary by manufacturer or region. Performance figures are guidelines only, and actual performance may vary. Photos may not represent actual vehicles or exact configurations. Content based on report preparer's input is subject to the accuracy of the input provided.

Data Version: 11289. Data Updated: Jun 28, 2020 9:51:00 PM PDT.



## COUNCIL PACKET

Vehicle: [Fleet] 2021 Chevrolet Silverado 3500HD (CK30943) 4WD Crew Cab 172" Work Truck (✓  
Complete)

### Standard Equipment

#### Package

Trailer Package includes trailer hitch, 7-pin connector and (CTT) Hitch Guidance (Deleted when (ZW9) pickup bed delete is ordered.)

#### Mechanical

Engine, 6.6L V8 with Direct Injection and Variable Valve Timing, gasoline (401 hp [299 kW] @ 5200 rpm, 464 lb-ft of torque [629 N-m] @ 4000 rpm) (STD)

Transmission, 6-speed automatic, heavy-duty (STD) (Requires (L8T) 6.6L V8 gas engine.)

Rear axle, 3.73 ratio (Requires (L8T) 6.6L V8 gas engine. Not available with (L5P) Duramax 6.6L Turbo-Diesel V8 engine.)

Durabed, pickup bed (STD)

GVWR, 11,500 lbs. (5216 kg) with single rear wheels (STD) (Included and only available with model CK30943 model and (L8T) 6.6L V8 gas engine or CC30903 and (L5P) Duramax 6.6L Turbo-Diesel V8 engine. Requires single rear wheels.)

Air filter, heavy-duty

Air filtration monitoring

Transfer case, two-speed electronic shift with push button controls (Requires 4WD models.)

Auto-locking rear differential

Four wheel drive

Cooling, external engine oil cooler

Cooling, auxiliary external transmission oil cooler

Battery, heavy-duty 720 cold-cranking amps/80 Amp-hr maintenance-free with rundown protection and retained accessory power (Included and only available with (L8T) 6.6L V8 gas engine.)

Alternator, 170 amps (Requires (L8T) 6.6L V8 gas engine.)

Recovery hooks, front, frame-mounted, Black (Not included when (VQY) Chrome recovery hooks, LPO is ordered.)

Frame, fully-boxed, hydroformed front section and a fully-boxed stamped rear section

Suspension Package

Steering, Recirculating ball with smart flow power steering system

Brakes, 4-wheel antilock, 4-wheel disc with DURALIFE rotors

Brake lining wear indicator

Capless Fuel Fill (Requires (L8T) 6.6L V8 gas engine. Not available with (ZW9) pickup bed delete.)

#### Exterior

Wheels, 18" (45.7 cm) painted steel (STD) (Requires single rear wheels.)

This document contains information considered Confidential between GM and its Clients uniquely. The information provided is not intended for public disclosure. Prices, specifications, and availability are subject to change without notice, and do not include certain fees, taxes and charges that may be required by law or vary by manufacturer or region. Performance figures are guidelines only, and actual performance may vary. Photos may not represent actual vehicles or exact configurations. Content based on report preparer's input is subject to the accuracy of the input provided.

Data Version: 11289. Data Updated: Jun 28, 2020 9:51:00 PM PDT.



Vehicle: [Fleet] 2021 Chevrolet Silverado 3500HD (CK30943) 4WD Crew Cab 172" Work Truck (✓  
Complete)

## Exterior

Tires, LT275/70R18E all-terrain, blackwall (STD) (Requires single rear wheels.)

Tire, spare LT275/70R18 all-terrain, blackwall (STD) (Included and only available with (QF6) LT275/70R18E all-terrain, blackwall tires with (E63) Durabed, pickup bed single rear wheel models. Available to order when (ZW9) pickup bed delete and (QF6) LT275/70R18E all-terrain, blackwall tires are ordered with single rear wheel models)

Single Rear Wheels (STD)

Tire carrier lock keyed cylinder lock that utilizes same key as ignition and door (Deleted with (ZW9) pickup bed delete.)

Bumpers, front, Black

Bumpers, rear, Black

CornerStep, rear bumper

BedStep, Black integrated on forward portion of bed on driver and passenger side (Deleted when (ZW9) pickup bed delete is ordered.)

Moldings, beltline, Black

Cargo tie downs (12), fixed, rated at 500 lbs per corner (Deleted with (ZW9) pickup bed delete.)

Front grille bar with "CHEVROLET" molded in Black includes Black mesh inserts with small Gold bowtie emblem.

Headlamps, halogen reflector with halogen Daytime Running Lamps

Taillamps, with incandescent tail, stop and reverse lights (Note: Trucks equipped with dual rear wheels will feature LED signature tail and stop lamps, with incandescent reverse lamp.)

Lamps, cargo area cab mounted integrated with center high mount stop lamp, with switch in bank on left side of steering wheel

Mirrors, outside high-visibility vertical trailering lower convex mirrors, manual-folding/extending (extends 3.31" [84.25mm]), molded in Black

Mirror caps, Black

Glass, solar absorbing, tinted

Door handles, Black grained

Tailgate and bed rail protection cap, top

Tailgate, locking, utilizes same key as ignition and door (Upgraded to (QT5) EZ Lift power lock and release tailgate when (ZLQ) WT Fleet Convenience Package or (PCV) WT Convenience Package is ordered. Not available with (ZW9) pickup bed delete.)

Tailgate, gate function manual, no EZ Lift (Deleted with (ZW9) pickup bed delete.)

This document contains information considered Confidential between GM and its Clients uniquely. The information provided is not intended for public disclosure. Prices, specifications, and availability are subject to change without notice, and do not include certain fees, taxes and charges that may be required by law or vary by manufacturer or region. Performance figures are guidelines only, and actual performance may vary. Photos may not represent actual vehicles or exact configurations. Content based on report preparer's input is subject to the accuracy of the input provided.

Data Version: 11289. Data Updated: Jun 28, 2020 9:51:00 PM PDT.



Vehicle: [Fleet] 2021 Chevrolet Silverado 3500HD (CK30943) 4WD Crew Cab 172" Work Truck (✓  
Complete )

**Entertainment**

Audio system, Chevrolet Infotainment 3 system, 7" diagonal color touchscreen, AM/FM stereo. Additional features for compatible phones include: Bluetooth audio streaming for 2 active devices, voice command pass-through to phone, wired Apple CarPlay and Android Auto capable. (STD)

Audio system feature, 6-speaker system (Requires Crew Cab or Double Cab model.)

Bluetooth for phone connectivity to vehicle infotainment system

**Interior**

Seats, front 40/20/40 split-bench with upper covered armrest storage (STD)

Seat trim, Vinyl

Seat adjuster, driver 4-way manual

Seat adjuster, passenger 4-way manual

Seat, rear 60/40 folding bench (folds up), 3-passenger (includes child seat top tether anchor) (Requires Crew Cab or Double Cab model.)

Floor covering, rubberized-vinyl (Not available with LPO floor liners.)

Steering wheel, urethane

Steering column, Tilt-Wheel, manual with wheel locking security feature

Instrument cluster, 6-gauge cluster featuring speedometer, fuel level, engine temperature, tachometer, voltage and oil pressure

Driver Information Center, 3.5" diagonal monochromatic display

Exterior Temperature Display located in radio display

Window, power front, drivers express up/down (Standard on Crew Cab and Double Cab models. On Regular Cab model, included and only available with (ZLQ) WT Fleet Convenience Package or (PCV) WT Convenience Package.)

Window, power front, passenger express down (Standard on Crew Cab and Double Cab models. On Regular Cab model, included and only available with (ZLQ) WT Fleet Convenience Package or (PCV) WT Convenience Package.)

Windows, power rear, express down (Not available with Regular Cab models.)

Door locks, power (Standard on Crew Cab and Double Cab models. On Regular Cab models, included and only available with (ZLQ) WT Fleet Convenience Package or (PCV) WT Convenience Package.)

Power outlet, front auxiliary, 12-volt

USB ports, 2 (first row) located on instrument panel

Air conditioning, single-zone

Air vents, rear, heating/cooling (Not available on Regular Cab models.)

Mirror, inside rearview, manual tilt

Assist handles front A-pillar mounted for driver and passenger, rear B-pillar mounted

This document contains information considered Confidential between GM and its Clients uniquely. The information provided is not intended for public disclosure. Prices, specifications, and availability are subject to change without notice, and do not include certain fees, taxes and charges that may be required by law or vary by manufacturer or region. Performance figures are guidelines only, and actual performance may vary. Photos may not represent actual vehicles or exact configurations. Content based on report preparer's input is subject to the accuracy of the input provided.

Data Version: 11289. Data Updated: Jun 28, 2020 9:51:00 PM PDT.



Vehicle: [Fleet] 2021 Chevrolet Silverado 3500HD (CK30943) 4WD Crew Cab 172" Work Truck (✓ Complete)

**Safety-Mechanical**

StabiliTrak, stability control system with Proactive Roll Avoidance and traction control includes electronic trailer sway control and hill start assist

**Safety-Exterior**

Daytime Running Lamps with automatic exterior lamp control

**Safety-Interior**

Airbags, Dual-stage frontal airbags for driver and front outboard passenger; Seat-mounted side-impact airbags for driver and front outboard passenger; Head-curtain airbags for front and rear outboard seating positions; Includes front outboard Passenger Sensing System for frontal outboard passenger airbag (Always use seat belts and child restraints. Children are safer when properly secured in a rear seat in the appropriate child restraint. See the Owner's Manual for more information.)

Rear Vision Camera (Deleted with (ZW9) pickup bed delete.)

Hitch Guidance dynamic single line to aid in trailer alignment for hitching (Deleted with (ZW9) pickup bed delete.)

Rear Seat Reminder (Requires Crew Cab or Double Cab model.)

Teen Driver a configurable feature that lets you activate customizable vehicle settings associated with a key fob, to help encourage safe driving behavior. It can limit certain available vehicle features, and it prevents certain safety systems from being turned off. An in-vehicle report card gives you information on driving habits and helps you to continue to coach your new driver

Tire Pressure Monitoring System with Tire Fill Alert (does not apply to spare tire)

**Processing-Other**

Trailer Information Label provides max trailer ratings for tongue weight, conventional, gooseneck and 5th wheel trailering (Not available with (ZW9) pickup bed delete.)

**WARRANTY**

Warranty Note: <<< Preliminary 2021 Warranty >>>

Basic Years: 3

Basic Miles/km: 36,000

Drivetrain Years: 5

Drivetrain Miles/km: 60,000

Drivetrain Note: HD Duramax Diesel: 5 Years/100,000 Miles; Qualified Fleet Purchases: 5 Years/100,000 Miles

Corrosion Years (Rust-Through): 6

Corrosion Years: 3

Corrosion Miles/km (Rust-Through): 100,000

Corrosion Miles/km: 36,000

Roadside Assistance Years: 5

Roadside Assistance Miles/km: 60,000

Roadside Assistance Note: HD Duramax Diesel: 5 Years/100,000 Miles; Qualified Fleet Purchases: 5 Years/100,000 Miles

Maintenance Note: 1 Year/1 Visit

This document contains information considered Confidential between GM and its Clients uniquely. The information provided is not intended for public disclosure. Prices, specifications, and availability are subject to change without notice, and do not include certain fees, taxes and charges that may be required by law or vary by manufacturer or region. Performance figures are guidelines only, and actual performance may vary. Photos may not represent actual vehicles or exact configurations. Content based on report preparer's input is subject to the accuracy of the input provided.

Data Version: 11289. Data Updated: Jun 28, 2020 9:51:00 PM PDT.



Vehicle: [Fleet] 2021 Chevrolet Silverado 3500HD (CK30943) 4WD Crew Cab 172" Work Truck ( Complete )

**Window Sticker**

**SUMMARY**

[Fleet] 2021 Chevrolet Silverado 3500HD (CK30943) 4WD Crew Cab 172" Work Truck MSRP:\$43,100.00

Interior:Jet Black, Vinyl seat trim

Exterior 1:Red Hot

Exterior 2:No color has been selected.

Engine, 6.6L V8 with Direct Injection and Variable Valve Timing, gasoline

Transmission, 6-speed automatic, heavy-duty

**OPTIONS**

CODE	MODEL	MSRP
CK30943	[Fleet] 2021 Chevrolet Silverado 3500HD (CK30943) 4WD Crew Cab 172" Work Truck	\$43,100.00
<b>OPTIONS</b>		
1WT	Work Truck Preferred Equipment Group	\$0.00
AE7	Seats, front 40/20/40 split-bench	\$0.00
AQQ	Remote Keyless Entry	Inc.
DBG	Mirrors, outside power-adjustable vertical trailing with heated upper glass	Inc.
E63	Durabed, pickup bed	\$0.00
FE9	Emissions, Federal requirements	\$0.00
G1Y	GVWR, 11,500 lbs. (5216 kg) with single rear wheels	Inc.
G7C	Red Hot	\$0.00
GT4	Rear axle, 3.73 ratio	\$0.00
H2G	Jet Black, Vinyl seat trim	\$0.00
IOR	Audio system, Chevrolet Infotainment 3 system, 7" diagonal color touchscreen, AM/FM stereo.	\$0.00
K34	Cruise control, electronic	Inc.
L8T	Engine, 6.6L V8 with Direct Injection and Variable Valve Timing, gasoline	\$0.00
MYD	Transmission, 6-speed automatic, heavy-duty	\$0.00
PYT	Wheels, 18" (45.7 cm) painted steel	\$0.00
QF6	Tires, LT275/70R18E all-terrain, blackwall	\$0.00

This document contains information considered Confidential between GM and its Clients uniquely. The information provided is not intended for public disclosure. Prices, specifications, and availability are subject to change without notice, and do not include certain fees, taxes and charges that may be required by law or vary by manufacturer or region. Performance figures are guidelines only, and actual performance may vary. Photos may not represent actual vehicles or exact configurations. Content based on report preparer's input is subject to the accuracy of the input provided.

Data Version: 11289. Data Updated: Jun 28, 2020 9:51:00 PM PDT.



COUNCIL PACKET

Vehicle: [Fleet] 2021 Chevrolet Silverado 3500HD (CK30943) 4WD Crew Cab 172" Work Truck ( Complete )

QT5	Tailgate, gate function manual with EZ Lift	Inc.	
SRW	Single Rear Wheels		\$0.00
ZLQ	WT Fleet Convenience Package		\$760.00
ZYG	Tire, spare LT275/70R18 all-terrain, blackwall		\$0.00
<b>SUBTOTAL</b>			<b>\$43,860.00</b>
Adjustments Total			\$0.00
Destination Charge			\$1,595.00
<b>TOTAL PRICE</b>			<b>\$45,455.00</b>

FUEL ECONOMY

Est City:N/A

Est Highway:N/A

Est Highway Cruising Range:N/A

This document contains information considered Confidential between GM and its Clients uniquely. The information provided is not intended for public disclosure. Prices, specifications, and availability are subject to change without notice, and do not include certain fees, taxes and charges that may be required by law or vary by manufacturer or region. Performance figures are guidelines only, and actual performance may vary. Photos may not represent actual vehicles or exact configurations. Content based on report preparer's input is subject to the accuracy of the input provided.

Data Version: 11289. Data Updated: Jun 28, 2020 9:51:00 PM PDT.



# COUNCIL PACKET

CITY OF RIVERSIDE  
 POOLED CASH REPORT (FUND 999)  
 AS OF: AUGUST 31ST, 2020

FUND ACCOUNT#	ACCOUNT NAME	BEGINNING BALANCE	CURRENT ACTIVITY	CURRENT BALANCE
<u>CLAIM ON CASH</u>				
001-1110	CHECKING ACCT-GENERAL FUND	302,686.56 (	45,882.82)	256,803.74
002-1110	CHECKING ACCT-FIRE DEP.	89,245.68 (	3,930.22)	85,315.46
110-1110	CHECKING ACCT-ROAD USE TAX	172,457.11	8,662.03	181,119.14
121-1110	CHECKING ACCT-LOST	261,382.68	10,219.44	271,602.12
125-1110	CHECKING ACCT-TIF	0.00	0.00	0.00
145-1110	CHECKING ACCT-CASINO REVENUE	161,817.87	108,754.05	270,571.92
200-1110	CHECKING ACCT-DEBT SERVICE	0.00	0.00	0.00
301-1110	CHECKING ACCT-CAP PROJECTS	391,542.20 (	223,853.94)	167,688.26
302-1110	COMMUNITY CENTER FUNDS	910,703.30	3,502.08	914,205.38
600-1110	CHECKING ACCT-WATER	517,664.09	12,636.87	530,300.96
610-1110	CHECKING ACCT-SEWER	226,304.07	34,019.90	260,323.97
670-1110	CHECKING ACCT-GARBAGE	9,834.39	266.89	10,101.28
680-1110	CHECKING ACCT-STORM WATER	<u>6,149.35</u>	<u>1,603.39</u>	<u>7,752.74</u>
TOTAL CLAIM ON CASH		<u>3,049,787.30 (</u>	<u>94,002.33)</u>	<u>2,955,784.97</u>

CASH IN BANK - POOLED CASH

999-1110	CASH IN BANK	( 4,511.14)	53,439.52	48,928.38
999-1112	PEOPLES BANK MONEY MARKET	1,704,453.33 (	166,738.02)	1,537,715.31
999-1114	HILLS BANK	181,997.18	15,794.09	197,791.27
999-1115	CB FUND	102,135.59	151.80	102,287.39
999-1116	COMMUNITY BUILDING CD #18936	297,341.89	0.00	297,341.89
999-1117	COMMUNITY BUILDING CD#18975	288,943.19	1,893.57	290,836.76
999-1118	WATER RESERVES CD#921190	257,144.63	0.00	257,144.63
999-1119	COMMUNITY BUILDING CD#19068	<u>222,282.63</u>	<u>1,456.71</u>	<u>223,739.34</u>
SUBTOTAL CASH IN BANK - POOLED CASH		<u>3,049,787.30 (</u>	<u>94,002.33)</u>	<u>2,955,784.97</u>

WAGES PAYABLE

999-2010	WAGES PAYABLE	<u>0.00</u>	<u>0.00</u>	<u>0.00</u>
SUBTOTAL WAGES PAYABLE		<u>0.00</u>	<u>0.00</u>	<u>0.00</u>
TOTAL CASH IN BANK - POOLED CASH		<u>3,049,787.30 (</u>	<u>94,002.33)</u>	<u>2,955,784.97</u>

DUE TO OTHER FUNDS - POOLED CASH

999-2100	DUE TO OTHER FUNDS	<u>3,049,787.30 (</u>	<u>94,002.33)</u>	<u>2,955,784.97</u>
TOTAL DUE TO OTHER FUNDS		<u>3,049,787.30 (</u>	<u>94,002.33)</u>	<u>2,955,784.97</u>

# COUNCIL PACKET

9-16-2020 09:41 AM

CITY OF RIVERSIDE  
 POOLED CASH REPORT (FUND 999)  
 AS OF: AUGUST 31ST, 2020

PAGE: 2

FUND ACCOUNT#	ACCOUNT NAME	BEGINNING BALANCE	CURRENT ACTIVITY	CURRENT BALANCE
<u>DUE TO POOLED CASH</u>				
001-2020	ACCOUNTS PAYABLE	0.00	0.00	0.00
002-2020	ACCOUNTS PAYABLE	0.00	0.00	0.00
110-2020	ACCOUNTS PAYABLE	0.00	0.00	0.00
121-2020	ACCOUNTS PAYABLE	0.00	0.00	0.00
125-2020	ACCOUNTS PAYABLE	0.00	0.00	0.00
145-2020	ACCOUNTS PAYABLE	0.00	0.00	0.00
200-2020	ACCOUNTS PAYABLE	0.00	0.00	0.00
301-2020	ACCOUNTS PAYABLE	0.00	0.00	0.00
600-2020	ACCOUNTS PAYABLE	0.00	0.00	0.00
610-2020	ACCOUNTS PAYABLE	0.00	0.00	0.00
670-2020	ACCOUNTS PAYABLE	0.00	0.00	0.00
680-2020	ACCOUNTS PAYABLE	<u>0.00</u>	<u>0.00</u>	<u>0.00</u>
TOTAL DUE TO POOLED CASH		0.00	0.00	0.00

<u>DUE FROM OTHER FUNDS</u>				
999-1330	DUE FROM OTHER FUNDS	<u>0.00</u>	<u>0.00</u>	<u>0.00</u>
TOTAL DUE FROM OTHER FUNDS		0.00	0.00	0.00

<u>ACCOUNTS PAYABLE - POOLED CASH</u>				
999-2020	ACCOUNTS PAYABLE CONTROL	<u>0.00</u>	<u>0.00</u>	<u>0.00</u>
TOTAL ACCOUNTS PAYABLE POOLED CASH		0.00	0.00	0.00

\*\*\* PROOF CASH BALANCES \*\*\*

(A)		(B)		(C)	
CLAIM ON CASH	2,955,784.97	CLAIM ON CASH	2,955,784.97	CASH IN BANK	2,955,784.97
CASH IN BANK	<u>2,955,784.97</u>	DUE TO OTHER FUNDS	<u>2,955,784.97</u>	DUE TO OTHER FUNDS	<u>2,955,784.97</u>
DIFFERENCE	0.00		0.00		0.00

\*\*\* PROOF ACCOUNTS PAYABLE BALANCES \*\*\*

(D)		(E)		(F)	
AP PENDING	0.00	AP PENDING	0.00	DUE FROM OTHER FUNDS	0.00
DUE FROM OTHER FUNDS	<u>0.00</u>	ACCOUNTS PAYABLE	<u>0.00</u>	ACCOUNTS PAYABLE	<u>0.00</u>
DIFFERENCE	0.00		0.00		0.00

\*\*\* END OF REPORT \*\*\*

CITY OF RIVERSIDE  
MTD TREASURERS REPORT  
AS OF: AUGUST 31ST, 2020

JND	BEGINNING CASH BALANCE	M-T-D REVENUES	M-T-D EXPENSES	CASH BASIS BALANCE	NET CHANGE OTHER ASSETS	NET CHANGE LIABILITIES	ACCUAL ENDING CASH BALANCE
001-GENERAL FUND	302,686.56	6,421.94	53,548.64	255,559.86	0.00	1,243.88	256,803.74
002-FIRE DEPARTMENT	89,245.68	0.00	3,930.22	85,315.46	0.00	0.00	85,315.46
110-ROAD USE TAX	172,457.11	10,507.53	1,845.50	181,119.14	0.00	0.00	181,119.14
121-LOCAL OPTION SALES TAX	261,382.68	10,219.44	0.00	271,602.12	0.00	0.00	271,602.12
125-TIF	0.00	0.00	0.00	0.00	0.00	0.00	0.00
145-CASINO REVENUE FUND	161,817.87	109,421.12	667.07	270,571.92	0.00	0.00	270,571.92
200-DEBT SERVICE	0.00	0.00	0.00	0.00	0.00	0.00	0.00
301-CAPITAL PROJECTS	391,542.20	8,381.93	232,235.87	167,688.26	0.00	0.00	167,688.26
302-COMMUNITY CENTER FUNDS	910,703.30	3,502.08	0.00	914,205.38	0.00	0.00	914,205.38
600-WATER FUND	517,664.09	37,628.54	24,991.67	530,300.96	0.00	0.00	530,300.96
610-SEWER FUND	226,304.07	69,662.19	35,642.29	260,323.97	0.00	0.00	260,323.97
670-LANDFILL/GARBAGE	9,834.39	7,410.39	7,143.50	10,101.28	0.00	0.00	10,101.28
680-STORM WATER	6,149.35	1,603.39	0.00	7,752.74	0.00	0.00	7,752.74

RAND TOTAL	3,049,787.30	264,758.55	360,004.76	2,954,541.09	0.00	1,243.88	2,955,784.95
------------	--------------	------------	------------	--------------	------	----------	--------------

58

\*\*\* END OF REPORT \*\*\*

COUNCIL PACKET

CITY of RIVERSIDE FUND BALANCES 7-31-2020

FUND	NAME	BALANCE 7-31-20	RESERVES	AVAILABLE FY 20
001	GENERAL	\$ 256,803.74		\$ 256,803.74
002	FIRE	\$ 85,315.46	\$ (85,315.46)	\$ -
110	R.USE	\$ 181,119.14	\$ -	\$ 181,119.14
121	LOST	\$ 271,602.12	\$ -	\$ 271,602.12
145	CASINO	\$ 270,571.92	\$ -	\$ 270,571.92
200	DEBT	\$ -	\$ -	\$ -
301	CAP PRO	\$ 167,688.26	\$ -	\$ 167,688.26
302	CB FUNDS	\$ 914,205.38	\$ (914,205.38)	\$ -
600	WATER	\$ 530,300.96	\$ (55,566.00)	\$ 217,590.33
CD	RESERVE	\$ (257,144.63)		
610	SEWER	\$ 260,323.97	\$ (51,345.00)	\$ 208,978.97
670	GARBAGE	\$ 10,101.28	\$ -	\$ 10,101.28
680	STORM	\$ 7,752.74	\$ -	\$ 7,752.74
	TOTAL	\$ 2,955,784.97	\$ (1,363,576.47)	\$ 1,592,208.50

CITY of RIVERSIDE FUND BALANCES 7-31-2020

POOLED CASH BALANCE 7/31/20			
COMM. BUILDING SET A SIDE		INTEREST RATE	
CD	18936 \$	297,341.89	2.60%
CD	18975 \$	290,836.76	2.60%
CD	19068 \$	223,739.34	2.60%
SAV	67928 \$	102,287.39	1.76%
<b>TOTAL 302 FUND</b>	<b>\$</b>	<b>914,205.38</b>	
<b>CD</b>	<b>..29089 \$</b>	<b>257,144.63</b>	<b>2.82% WATER RESERVES @ HILLS BANK</b>
CHECK	35308 \$	48,928.38	0.85%
MM	67545 \$	1,537,715.31	1.16%
HILLS	2656940 \$	197,791.27	0.30% WATER ACH BALANCE
<b>TOTAL</b>	<b>\$</b>	<b>2,955,784.97</b>	
<b>LESS RESERVES</b>	<b>\$</b>	<b>(1,363,576.47)</b>	
<b>LIQUID CASH</b>	<b>\$</b>	<b>1,592,208.50</b>	<b>8/31/2020</b>

COUNCIL PACKET

RIVERSIDE CASINO & GOLF RESORT		
PAYMENT IN LIEU OF ADMISSION FEE AGREEMENT		
8/31/2006	THROUGH 7-31-2014	\$1,700,000.00
9/29/2014	THROUGH 8-31-2022	\$1,200,000.00
1.35% +/-		90,000,000.00
2015	\$	(56,105.56)
2016	\$	(74,080.02)
2017	\$	(52,169.08)
2018	\$	(54,919.06)
2019	\$	15,430.53
2020	\$	(159,708.03) COVID-19
TOTAL	\$	(381,551.22) SHORT OF AGREEMENT

# COUNCIL PACKET

## City Admin

---

**From:** Ryan Schlabaugh <rschlabaugh@cityofkalona.org>  
**Sent:** Monday, September 14, 2020 12:00 PM  
**To:** City Admin; 'Kelly Litwiller'  
**Subject:** Re: trick or treat night

Undecided in kalona but I'd assume something like Wellman.

Thanks

---

**From:** City Admin <admin@cityofriversideiowa.com>  
**Date:** Monday, September 14, 2020 at 11:06 AM  
**To:** Ryan Schlabaugh <rschlabaugh@cityofkalona.org>, 'Kelly Litwiller' <cityadministrator@cityofwellman.com>  
**Subject:** trick or treat night

Hi,

What are your communities doing for Halloween? I talked to Council about checking with both of you, so hopefully we can be the same so one community doesn't get inundated.

Thanks,

*Christine Yancey*

City Administrator  
City of Riverside, Iowa  
319-648-3501

[admin@cityofriversideiowa.com](mailto:admin@cityofriversideiowa.com)

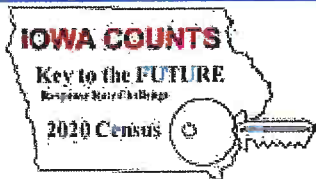

# COUNCIL PACKET

## City Admin

---

**From:** Kelly Litwiller <cityadministrator@cityofwellman.com>  
**Sent:** Monday, September 14, 2020 11:10 AM  
**To:** City Admin; 'Mr. Ryan Schlabaugh'  
**Subject:** RE: trick or treat night

We are only doing trick or treating from 5:30 – 7:30 on the 31<sup>st</sup> – we cancelled all other functions we usually do

---

**From:** City Admin <admin@cityofriversideiowa.com>  
**Sent:** Monday, September 14, 2020 11:07 AM  
**To:** 'Mr. Ryan Schlabaugh' <rschlabaugh@cityofkalona.org>; Kelly Litwiller <cityadministrator@cityofwellman.com>  
**Subject:** trick or treat night

Hi,

What are your communities doing for Halloween? I talked to Council about checking with both of you, so hopefully we can be the same so one community doesn't get inundated.

Thanks,

*Christine Yancey*

City Administrator  
City of Riverside, Iowa  
319-648-3501

[admin@cityofriversideiowa.com](mailto:admin@cityofriversideiowa.com)

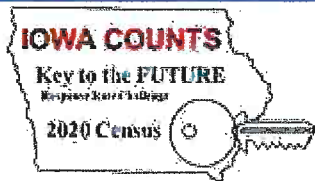



# FALL HOME IMPROVEMENT



With the growth of business, the number of staff employed by The Appliance Barn is grown from 12 to 24. Above Brylee's desk is a sign that reads, "The harder you work the luckier you get." He has similar signs throughout the store to keep his dedicated staff motivated.

In order to keep up with the growth of customers, both consumer and commercial, Brylee and they will have to build a new warehouse somewhere in Kalona.

When he was 21 years old, shortly after he married Landon's daughter Ramona, Brylee drafted a succession plan. He worked two years in inventory and in sales for five years, and during two years as a manager. Landon retired in 2012, leaving Brylee drawing trucks.

Brylee managed the business for two years before he purchased it in 2012, working out a purchase agreement with Ken and Landon. Ken continues to work as service manager.

After living in Iowa City for the past several years, Brylee and Ramona have purchased a new home on J Avenue in Kalona and are having it remodeled before moving in. "We definitely need the kitchen redone to include the smart appliances that we sell," he said.

"We both grew up in Kalona and graduated from IMS," Brylee said.

"We want our children to grow up here and attend the local schools." Their children are Kate, 6; Sybil, 4; and Jude, 2.

## How to host a socially distant trunk-or-treat

Halloween celebrations are social by nature, so celebrants will have to get creative if they want to show off their costumes and cash in on candy in 2020.

- Host the event in a big parking lot where it's easy to stay socially distant. Trunk-or-treats can take place in suburban neighborhoods, but that might make it difficult for participating kids and their parents to stay six feet apart from other families. If possible, arrange to host the event in a large, empty parking lot so kids can walk from one car to the other without compromising social distancing regulations. Make sure cars are at least six feet apart, and ideally even further apart so families can comfortably maintain their distance from one another.

- Limit participants. Organizers should limit the number of participants so everyone involved can safely stay six feet apart. If the event will

be in a large parking lot, encourage parents to sign up early and let them know only a limited number of cars will be allowed to park in the lot and participate in the event.

- Create an age-specific schedule. An age-specific schedule can help participants have fun and reduce their exposure to other people. Halloween 2020 is on a Saturday, so trunk-or-treat organizers can stagger the times kids are out and about throughout the day.

- Encourage all participants to wear masks. The Centers for Disease Control and Prevention notes that masks can slow the spread of COVID-19 by protecting Halloween celebrants from people who have the virus but are asymptomatic. Masks also can reduce the likelihood that asymptomatic people unknowingly spread the virus to others. Parents and youngsters participating in trunk-or-treat events should wear masks.



**Excavating • Earth Moving  
Soil Conservation  
Backhoe • Ponds**

**KEVIN KOS**  
1440 Larch Avenue, Kalona, IA 52247 • Cell 319-936-7595



**Excavating**

**ALL YOUR ROOFING & CONSTRUCTION NEEDS**

**CALL US TODAY!**  
**319-656-5420**

**Brenneman Builders**  
CUSTOM ROOFING

[www.Brennemanbuilders.com](http://www.Brennemanbuilders.com)

## COUNCIL PACKET

and other ornamental features.

- b. Gutters and downspouts.
  - c. Awnings and canopies.
  - d. Bay windows.
2. Air-conditioning equipment.
  3. Uncovered decks, patios and stoops which are at least ten (10) feet from any lot line.
  4. Retaining walls which are at least three (3) feet from the rear lot line.
  5. Non-nuisance landscaping, vegetation, arbors, trellises, flagpoles and the like shall be allowed in all yards.
- D. **Yards and Visibility.** On a corner lot in any district, nothing shall be erected, placed, planted or allowed to grow in such a manner as materially to impede vision between a height of three and ten feet above the centerline grades of the intersecting streets in the area bounded by the street lines of such corner lots and a line joining points along said street lines twenty feet from the point of the intersection (see Visibility Diagram in the appendix).

6. **Decks.** A permit is needed for the construction of any deck whether it is attached to the house or not. Each application for a deck permit shall be submitted prior to the installation of the deck and shall be approved or denied by the Zoning Administrator.

7. **Driveways.** All driveways from the paved portion of the street to the garage, carport or off-street parking area and loading zones shall be paved with asphalt or Portland cement concrete pavement, as approved by the City, and shall be so graded and drained to dispose of all surface water accumulation within the area. A driveway shall be a minimum of 10 feet width at the street and meet all City of Riverside design standards.

### 8. **Off-street Parking and Loading.**

- A. **Off-Street Parking:** All off-street parking areas shall be paved with asphalt or Portland cement concrete pavement as approved by the City, and shall be so graded and drained to dispose of all surface water accumulation within the area. This requirement shall not be enforced during periods of declared snow emergency pursuant to Section 69.10 of the City Code. In addition, all uses shall meet the following standards for off-street parking areas:
1. **Churches:** one (1) parking space on the lot for each 5 seats in the main auditorium.

## COUNCIL PACKET

2. Colleges, universities, institutions of higher learning, and equivalent private or parochial schools: one (1) parking space for each employee and one (1) parking space for each five (5) students.
3. Dwellings: two (2) parking spaces on the lot for each dwelling unit in the building.
4. Elementary, junior high, high school and equivalent private or parochial schools: one (1) parking space for each employee and office plus one (1) parking space for each 300 square feet of gross floor area in auditorium or gymnasium and one parking space for each ten (10) students.
5. Greenhouses and nurseries: one (1) parking space per 1,000 square feet of enclosed floor area.
6. Hotels and motels: one (1) parking space per room plus one (1) parking space for each employee.
7. Nursery schools: one (1) parking space per employee.
8. Offices/clinics: one (1) parking space per 300 square feet of gross floor area.
9. Public buildings and facilities: one (1) parking space for each 300 square feet of gross floor area or one (1) parking space for each 5 seats in the main assembly area, whichever is greater.
10. Roadside stands: one (1) parking space for each 50 square feet of enclosed floor area.
11. Sales and service buildings: one (1) parking space per 300 square feet of gross floor area.
12. All other commercial uses shall provide one (1) parking space on the lot for each 300 square feet of floor area.
13. All industrial uses shall provide one (1) parking space on the lot for each two (2) employees of maximum number employed at any one time.

B. Off-street Loading: All off-street loading areas shall meet the following standards:

1. All activities or uses within each zoning district shall be provided with adequate receiving facilities accessible by motor vehicle off any adjacent service drive or open space on the same zoning lot.
2. Loading shall not be permitted to block public right-of-way.

9. **Sign Regulations.** The following regulations shall apply to all zoning districts:

- A. No sign may be lighted in a manner which impairs the vision of the driver of any motor vehicle.

# COUNCIL PACKET

City of Riverside  
Administrator Report  
September 21, 2020

- Staff is holding daily meetings from 8:00-8:15, 8:30 to discuss the tasks for the day and any updates on projects. We practice social distancing.
- Washington zoom meetings for updates
- Phone meetings with council members
- Payroll review
- Agenda prep
- Code Update
  - Sent to the attorney for review-**done**
  - 7/20 set Public Hearing for 8/3-**done**
  - 8/3 Public Hearing, 1<sup>st</sup> reading-**done**
  - 8/17 - 2<sup>nd</sup> reading-**done**
  - 9/8 – 3<sup>rd</sup> reading-**done**
  - 9/24 – publish
- Nuisance issues
- Project update emails
- Nesper Sign-possible sign at fire station
- Review of past due water bills
- Phone calls from letters on weeds/brush
- Worked on FEMA/State COVID and Derecho Grants
- COVID, Cares webinars
- Checked on parking in City Code
- Checked on ATV requirements per state code
- Notified successful grant applicants
- Worked with ITC-trail replanting
- New member for Trail Committee
- Applied for reimbursement for Safe Routes to School
- Research on wording for publication for code
- Meeting with staff on weeds, tree trimming
- Worked with mayor on possible ambulance donation, prepare for council meeting

## Public Works:

- Mowed parks, ball diamonds
- Don watering flowers, weeding
- Cleaning, disinfecting bathrooms 2/day
- Cleaning equipment and shop
- Emptied trash in parks and downtown
- Get park ready for Shop the Park
- Installed door sweeps at city hall and fire department
- Weeding at all parks
- Ordered new Building Code books
- Maintenance on generator
- Mulched trees in parks

## COUNCIL PACKET

- Working with electrician on Delta Shield project, city hall lights
- Graded roads at Hall Park
- Met with Overhead Door-shop door malfunction
- Jay-fence permit
- Jay-Temporary permit for Dollar General