

**CITY OF RIVERSIDE COUNCIL AGENDA
RIVERSIDE CITY HALL COUNCIL CHAMBERS
60 N GREENE STREET**

Special Meeting

Friday , July 26, 2019 at 6:00 PM

6:00 PM - Special Meeting

NOTICE TO THE PUBLIC: This is a meeting of the City Council to conduct the regular business of the City. Every item on the agenda is an item of discussion and action if needed.

1. CALL MEETING TO ORDER: Mayor Schneider

- Pledge of Allegiance
- Roll Call

2. APPROVAL OF AGENDA

3. Sidewalk at 381 E 4th street

4. Sidewalk on Hickory between Sycamore and Schnoebelen Streets

5. Adjourn Special Council Meeting

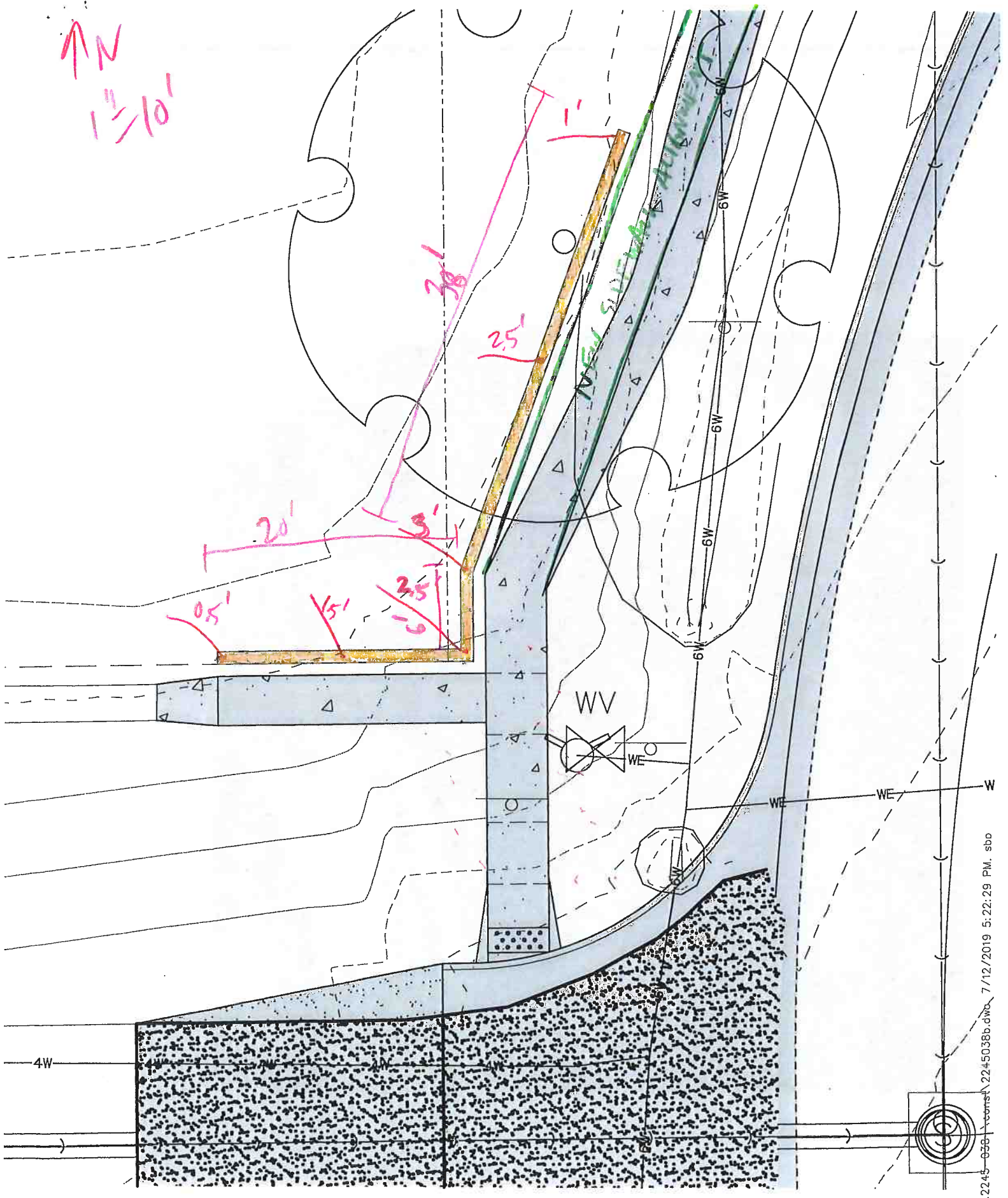

Becky

From: Sanders, Brenda <Brenda.Sanders@iowadot.us>
Sent: Tuesday, July 23, 2019 6:53 AM
To: Scott Pottorff; Van Dyke, Mark
Cc: becky@cityofriversideiowa.com; mayor@cityofriversideiowa.com; Phillips, James; Webb, James; Armstrong, James; Giarmo, Lauren; admin@cityofriversideiowa.com
Subject: RE: Highway 22 Riverside

What happens on private property is beyond our jurisdiction unless it impedes highway sight distance from side roads. Please Verify that all of the wall is placed on private property.



Thank you,

City Admin

From: Mayor <mayor@cityofrivsideiowa.com>
Sent: Tuesday, July 23, 2019 3:40 PM
To: Armstrong, James
Cc: Sanders, Brenda; Scott Pottorff; Van Dyke, Mark; becky@cityofrivsideiowa.com; Phillips, James; Webb, James; Giarmo, Lauren; admin@cityofrivsideiowa.com
Subject: Re: Highway 22 Riverside
Categories: Red Category

That's what I thought you were saying. I wanted to confirm. Thanks for the clarification.

I would also like to know if there's anything else that can be done to minimize the chance of vehicles leaving the roadway and potentially causing damage or injury at this property. I believe this has happened on multiple occasions in the past in case you were not aware.

On Jul 23, 2019, at 3:28 PM, Armstrong, James <James.Armstrong@iowadot.us> wrote:

Mayor,

There is no justification related to safety or design criteria to support putting in a retaining wall. If this was necessary to meet ADA requirements or to address and protect the clearzone then it would warrant designing and constructing as a justified cost.

If we need to discuss than please contact me.

Respectfully,

<image002.png>**JIM ARMSTRONG, P.E.**

DISTRICT 5 ENGINEER

HIGHWAY ADMINISTRATION

iowadot.gov

<image003.png> Iowa Department of Transportation

Office: 641-472-4171

<image004.png> @iowadot <image005.png> @iowadot

Cell: 641-919-9125

From: Mayor <mayor@cityofrivsideiowa.com>
Sent: Tuesday, July 23, 2019 3:21 PM
To: Armstrong, James <James.Armstrong@iowadot.us>
Cc: Sanders, Brenda <Brenda.Sanders@iowadot.us>; Scott Pottorff <S.pottorff@mmsconsultants.net>; Van Dyke, Mark <Mark.VanDyke@iowadot.us>; becky@cityofrivsideiowa.com; Phillips, James <James.Phillips@iowadot.us>; Webb, James <James.Webb@iowadot.us>; Giarmo, Lauren <LAUREN.GIARMO@iowadot.us>; admin@cityofrivsideiowa.com
Subject: Re: Highway 22 Riverside

Jim,

Can you be more specific on your statement that the design is unwarranted?

On Jul 23, 2019, at 3:16 PM, Armstrong, James <James.Armstrong@iowadot.us> wrote:

DOT and our project funds will not be party to a decision to spend money on an unwarranted design. I would caution the City of Riverside in proceeding to do so.

Respectfully,

<image010.png>**JIM ARMSTRONG, P.E.**

DISTRICT 5 ENGINEER

HIGHWAY ADMINISTRATION

iowadot.gov

<image011.png> Iowa Department of Transportation

Office: 641-472-4171

<image012.png> @iowadot

<image013.png> @iowadot

Cell: 641-919-9125

From: Sanders, Brenda

Sent: Tuesday, July 23, 2019 6:53 AM

To: Scott Pottorff <S.pottorff@mmsconsultants.net>; Van Dyke, Mark

<Mark.VanDyke@iowadot.us>

Cc: becky@cityofriversideiowa.com; mayor@cityofriversideiowa.com; Phillips, James

<James.Phillips@iowadot.us>; Webb, James <James.Webb@iowadot.us>; Armstrong,

James <James.Armstrong@iowadot.us>; Giarmo, Lauren

<LAUREN.GIARMO@iowadot.us>; admin@cityofriversideiowa.com

Subject: RE: Highway 22 Riverside

What happens on private property is beyond our jurisdiction unless it impedes highway sight distance from side roads. Please Verify that all of the wall is placed on private property.

<image014.png>

Thank you,

<image015.jpg>

From: Scott Pottorff <S.pottorff@mmsconsultants.net>

Sent: Monday, July 22, 2019 4:55 PM

To: Sanders, Brenda <Brenda.Sanders@iowadot.us>; Van Dyke, Mark

<Mark.VanDyke@iowadot.us>

Cc: becky@cityofriversideiowa.com; mayor@cityofriversideiowa.com; Phillips, James

<James.Phillips@iowadot.us>; Webb, James <James.Webb@iowadot.us>; Armstrong,

James <James.Armstrong@iowadot.us>; Giarmo, Lauren

<LAUREN.GIARMO@iowadot.us>; admin@cityofriversideiowa.com

Subject: RE: Highway 22 Riverside

What if the wall was constructed outside of the ROW here?

<image016.png> **Scott Pottorff, P.E.**

Project Manager

Ofc: (319) 351-8282

Cell: (319) 631-0365

S.pottorff@mmsconsultants.net

mmsconsultants.net

This email message is for the sole use of the intended recipient(s) and may contain confidential and privileged information. Any unauthorized review, use, disclosure or distribution is prohibited. If you are not the intended recipient, please contact the sender by reply email and destroy all copies of the original message.

From: Sanders, Brenda [<mailto:Brenda.Sanders@iowadot.us>]

Sent: Thursday, July 18, 2019 4:27 PM

To: Scott Pottorff; Van Dyke, Mark

Cc: becky@cityofriversideiowa.com; mayor@cityofriversideiowa.com; Phillips, James; Webb, James; Armstrong, James; Giarmo, Lauren; admin@cityofriversideiowa.com

Subject: RE: Highway 22 Riverside

Scott,

After discussion with Jim Armstrong, District Engineer, it has been decided that we do not support a retaining wall constructed in ROW for this area. This area does not warrant a retaining wall for the requested reason so let's not deviate from the current design.

If the City has additional information to discuss with the DOT concerning this area that we do not currently have, they may contact either Mark Van Dyke or Jim Armstrong to discuss with them further. Mark Van Dyke will return on July 24th.

Mark Van Dyke – Assistant District Engineer

641-469-4003

Mark.vandyke@iowadot.us

James Armstrong District Engineer

641-472-4171

James.armstrong@iowadot.us

Thank you,

<image015.jpg>

From: Scott Pottorff <S.pottorff@mmsconsultants.net>

Sent: Tuesday, July 16, 2019 9:58 AM

To: Van Dyke, Mark <Mark.VanDyke@iowadot.us>

Cc: becky@cityofriversideiowa.com; mayor@cityofriversideiowa.com; Phillips, James <James.Phillips@iowadot.us>; Sanders, Brenda <Brenda.Sanders@iowadot.us>; Webb, James <James.Webb@iowadot.us>; Armstrong, James

<James.Armstrong@iowadot.us>; Giarmo, Lauren <LAUREN.GIARMO@iowadot.us>;
admin@cityofriversideiowa.com

Subject: RE: Highway 22 Riverside

The plans showed grading on to adjacent property in order to make the ADA sidewalks work at the NW corner of Highway 22 and 4th Street. In talking to the adjacent property owner he asked if the City could build a retaining wall instead. The reason is that he has had vehicles leave the roadway through the curve in the past and end up in his yard and home. He felt the slope up from the sidewalk almost was like a ramp if a vehicle did leave the roadway again and that a wall may help protect his home if that happened.

Attached is a preliminary design of a wall at this location. The City Council is OK with a wall at this location. I wanted to reach out to you to make sure the DOT was OK with a wall at this location. A portion of the wall would be within the ROW so I assume would require permission from the DOT.

Please review the attached and let me know if this would be OK. Let me know if you need additional information.

<image016.png> **Scott Pottorff, P.E.**

Project Manager

Ofc: (319) 351-8282

Cell: (319) 631-0365

S.pottorff@mmsconsultants.net

mmsconsultants.net

This email message is for the sole use of the intended recipient(s) and may contain confidential and privileged information. Any unauthorized review, use, disclosure or distribution is prohibited. If you are not the intended recipient, please contact the sender by reply email and destroy all copies of the original message.

From: Van Dyke, Mark [<mailto:Mark.VanDyke@iowadot.us>]

Sent: Monday, July 8, 2019 4:18 PM

To: Scott Pottorff

Cc: becky@cityofriversideiowa.com; mayor@cityofriversideiowa.com; Vanbuskirk, Christy; Phillips, James; Sanders, Brenda; Webb, James; Armstrong, James; Giarmo, Lauren

Subject: RE: Highway 22 Riverside

Scott,

The DOT doesn't need to be involved with the patch locations or the materials for the asphalt or patching on this project. The agreement does include some provisions related to the construction responsibilities under Section 6. The DOT may assist if requested and the city will be billed for any testing services the DOT performs.

Please keep us posted on the progress of this project and let us know if there are other specific issues or questions as the project moves forward.

Also – Christy Vanbuskirk no longer works in the District 5 Office (she does still work at the DOT). You don't need to include her on any correspondences but please include Jim Phillips.

<image017.png>**MARK VAN DYKE**
ASSISTANT DISTRICT ENGINEER
DISTRICT 5 OFFICE

iowadot.gov

<image018.png>Iowa Department of Transportation

Office: 641-469-4003

<image019.png>@iowadot

<image020.png>@iowadot

Cell: 641-919-8553

From: Scott Pottorff [<mailto:S.pottorff@mmsconsultants.net>]

Sent: Friday, June 28, 2019 8:36 AM

To: Vanbuskirk, Christy <Christy.Vanbuskirk@iowadot.us>; Sanders, Brenda <Brenda.Sanders@iowadot.us>; Van Dyke, Mark <Mark.VanDyke@iowadot.us>

Cc: becky@cityofriversideiowa.com; mayor@cityofriversideiowa.com

Subject: Highway 22 Riverside

The contractor is to begin milling on Highway 22 on Monday. From there we will mark patches on Wednesday. Concrete patching and curb and gutter work will begin the week of July 8. It is anticipated that asphalt work will begin around August 1st.

I wanted to reach out to see if the DOT intended to be involved in any of that, either helping determine patching locations or for materials for patching or asphalt. I also wanted to make sure we are providing the testing and inspections required in order to provide you with the proper documentation at the end of the project.

Up until now the majority of the work has either been underground or not within the Highway ROW but starting next week the major parts of work within the Highway ROW will be beginning and I want to let you know and to make sure we are able to provide you with documentation you need for this work.

Please let me know if you need to have materials or other staff for this work. Also what we need to make sure we provide you if your staff will not be involved very much.

[Sign up for our newsletter](#) – We promise short, meaningful updates just six times a year.

<image021.png>

Scott Pottorff, P.E.

Project Manager

Office: (319) 351-8282

Mobile: (319) 631-0365

S.pottorff@mmsconsultants.net

www.mmsconsultants.net

This email message is for the sole use of the intended recipient(s) and may contain confidential and privileged information. Any unauthorized review, use, disclosure or distribution is prohibited. If you are not the intended recipient, please contact the sender by reply email and destroy all copies of the original message

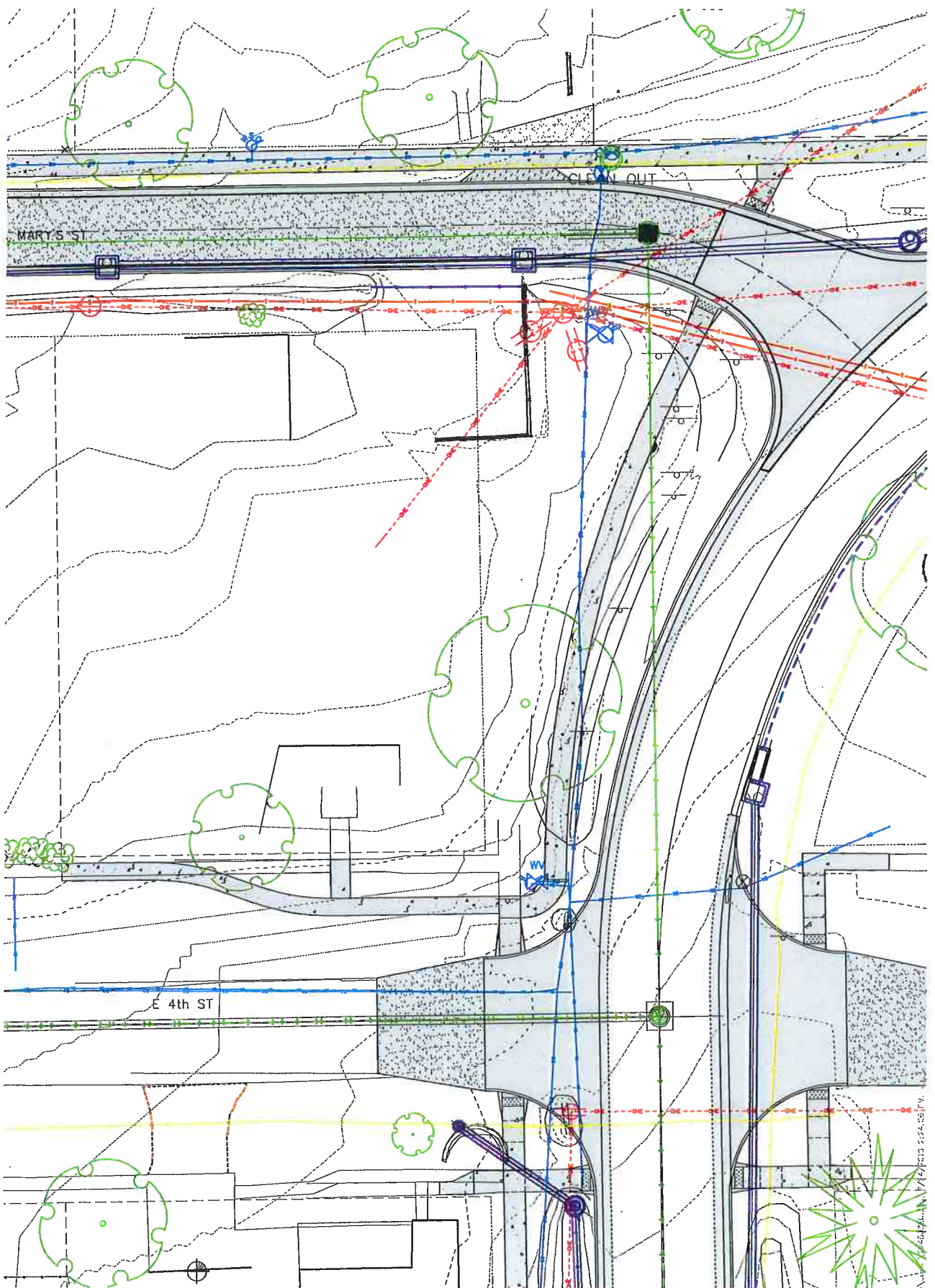

12/21/2011 10:44 AM

City Admin

From: Scott Pottorff <S.pottorff@mmsconsultants.net>
Sent: Thursday, July 25, 2019 11:02 AM
To: 'City Admin'
Subject: RE: New Sidewalk Slay

Categories: Red Category

I think the idea behind the changes was to try to come up with a plan which would not require a wall or grading outside of the ROW. If we stick with the original plan we would still need permission from Slay to grade on his property. That is where the whole wall idea came up when I started talking to him about getting permission to grade on his property.



Scott Pottorff, P.E.

Project Manager

Ofc: (319) 351-8282

Direct: (319) 339-4153

Cell: (319) 631-0365

S.pottorff@mmsconsultants.net

mmsconsultants.net

This email message is for the sole use of the intended recipient(s) and may contain confidential and privileged information. Any unauthorized review, use, disclosure or distribution is prohibited. If you are not the intended recipient, please contact the sender by reply email and destroy all copies of the original message.

From: City Admin [mailto:admin@cityofriversideiowa.com]
Sent: Thursday, July 25, 2019 10:46 AM
To: 'Scott Pottorff'
Subject: RE: New Sidewalk Slay

They did not want to go closer to the road by being on the other side of the hydrant. So if it could stay on the original alignment on Hwy 22 and then go farther down in the ROW on 4th they were good with that. You would just move the 4th Ave side down closer to the street as you were concerned about the steep slope from Hwy 22 going west correct? Otherwise it could just stay with the original alignment then there wouldn't be any additional cost. Are these changes being requested because a wall is not going to happen and the grading will be an issue? Is the grading possible without an alignment change?

From: Scott Pottorff [mailto:S.pottorff@mmsconsultants.net]
Sent: Thursday, July 25, 2019 9:33 AM
To: 'City Admin'
Subject: RE: New Sidewalk Slay

See below in red.

I guess I am unclear as to which way they want to go. It looks like you say they want to keep the previous alignment along the highway but change along 4th?

The attachment shows what I was thinking would be built with this project in orange and with 4th Street project in pink.

I should be in the office all day if we need to discuss on the phone.



Scott Pottorff, P.E.

Project Manager

Ofc: (319) 351-8282

Direct: (319) 339-4153

Cell: (319) 631-0365

S.pottorff@mmsconsultants.net

mmsconsultants.net

This email message is for the sole use of the intended recipient(s) and may contain confidential and privileged information. Any unauthorized review, use, disclosure or distribution is prohibited. If you are not the intended recipient, please contact the sender by reply email and destroy all copies of the original message.

From: City Admin [mailto:admin@cityofriversideiowa.com]

Sent: Wednesday, July 24, 2019 6:11 PM

To: 'Scott Pottorff'

Subject: RE: New Sidewalk Slay

Scott,

Met with Edgar, Tom and Allen this afternoon and there are several questions on the proposed changes to the sidewalk:

- Everyone preferred the sidewalk to retain the original alignment on Hwy 22, but is ok with running it part way up 4th St. **So make the change or leave the alignment along Highway 22 the same?**
- Will all of the changes at the intersection meet ADA requirements? **Any changes would have to comply with ADA**
- What will be any additional cost and/or delay to the project? **If we make the change to the new plan there will be a little extra cost for the sidewalk to Slay from the new alignment. I estimate about 10 SY additional sidewalk with the new plan. The only delay will be getting the grades worked out and getting it restaked.**
- It appears that the original excavation for the project cut pretty deep into the hillside-could the tree possibly be saved if it hadn't been cut in so deep? **The cut is required due to ADA requirements. The only way to have saved the tree is to move the sidewalk closer to the highway like we are now considering. Likely some roots would have still been damaged even at the new alignment but it would have been less damage.**

Thanks,

Chris

From: Scott Pottorff [mailto:S.pottorff@mmsconsultants.net]

Sent: Wednesday, July 24, 2019 2:30 PM

To: admin@cityofriversideiowa.com

Subject: New Sidewalk Slay

Please distribute and let me know what everyone thinks. I think we connect at his steps for now so that would be a little more sidewalk but would be able to continue to the west with the 4th Street project.



Scott Pottorff, P.E.

Project Manager

Ofc: (319) 351-8282

Direct: (319) 339-4153

Cell: (319) 631-0365

S.pottorff@mmsconsultants.net

mmsconsultants.net

SYCAMORE STREET

(HIGHWAY 22) HICKORY STREET

CENTERLINE OF BOX CULVERT
STA: 509+03.14
1987 FN-22-2(31)-21-92
STA: 40+38

GREENE STREET
STA: 501+56.52
1987 FN-22-2(31)-21-92
STA: 39+80.00

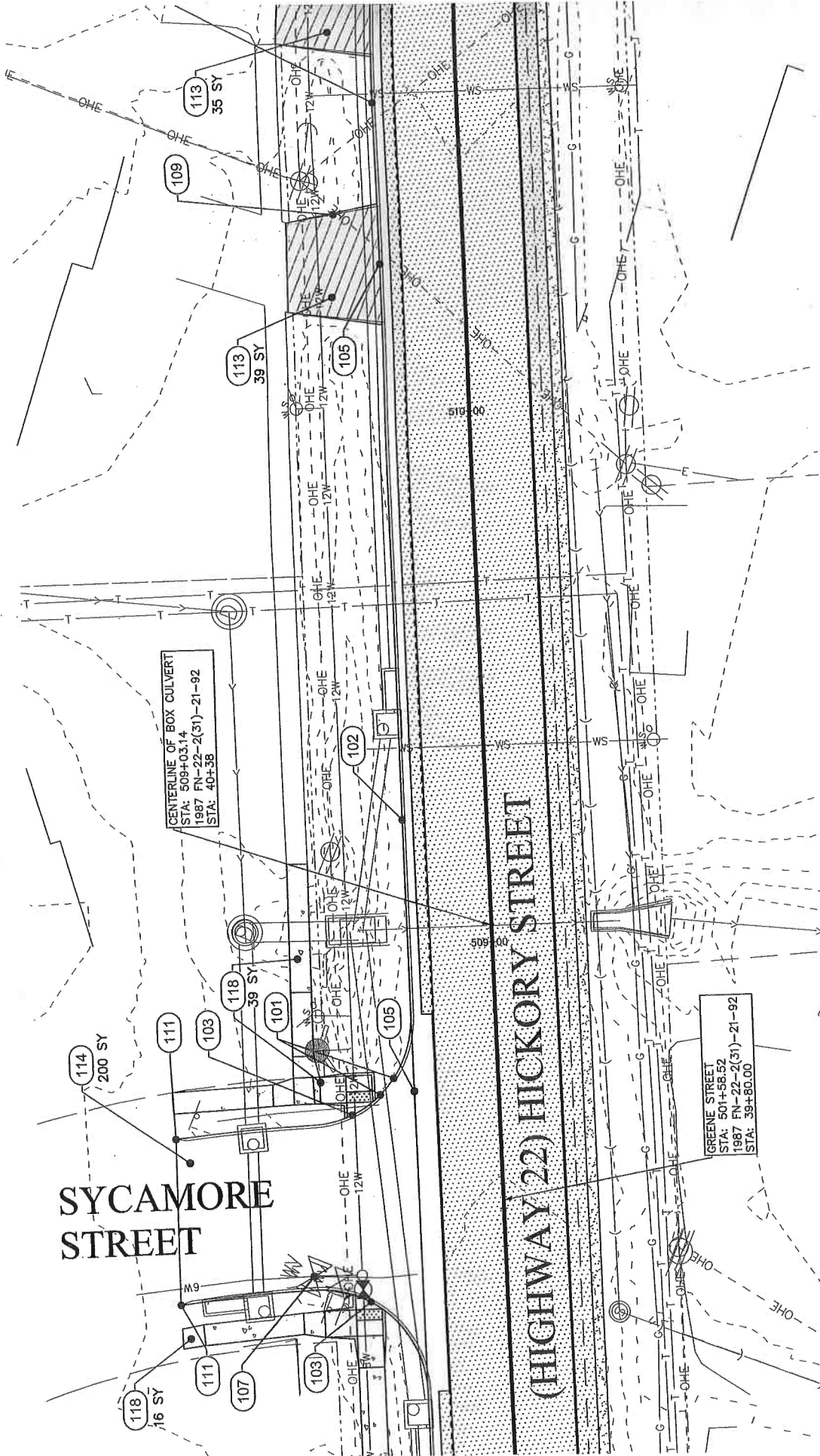

City Admin

From: Scott Pottorff <S.pottorff@mmsconsultants.net>
Sent: Wednesday, July 24, 2019 2:47 PM
To: admin@cityofriversideiowa.com
Subject: Sidewalk Between Sycamore and Schnoebelen

Right now the plans show replacing the westerly 40 feet of this sidewalk (the area of the bridge) with 4' wide sidewalk. There is an additional 288 feet to Schnoebelen. The cost to replace the remaining 288' at 4' wide is:

128 SY Sidewalk Removal \$8/SY - \$1,024.00
128 SY 4' Rock Base \$6/SY - \$768.00
128 SY 5" PCC Sidewalk \$39/SY - \$4,992.00
Total \$6,784.00

The cost to replace the whole length to 5' wide is as follows (would include replacement of curb ramp at Schnoebelen Street):

135 SY Sidewalk Removal \$8/SY - \$1,080.00
172 SY 4' Rock Base \$6/SY - \$1,032.00
172 SY 5" PCC Sidewalk \$39/SY - \$6,708.00
10 SF Detectable Warnings \$30/SF - \$300.00
Total \$9,120.00

The plans already show paving the two driveways between the sidewalk and the new curb and gutter.

Let me know if you have any questions.



Scott Pottorff, P.E.

Project Manager

Ofc: (319) 351-8282

Direct: (319) 339-4153

Cell: (319) 631-0365

S.pottorff@mmsconsultants.net

mmsconsultants.net

This email message is for the sole use of the intended recipient(s) and may contain confidential and privileged information. Any unauthorized review, use, disclosure or distribution is prohibited. If you are not the intended recipient, please contact the sender by reply email and destroy all copies of the original message.